

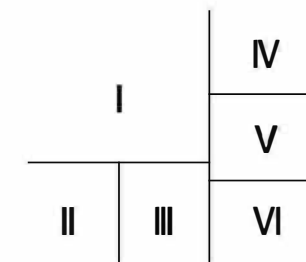

COMPANY IMAGES

Enterprise Production Chapter

Professional focus
on pursuing excellence to build optical
network connecting the world

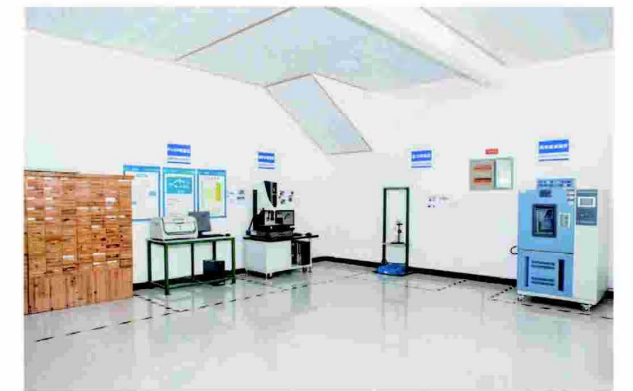

- I Patchcords cable workshop
- II Plastic Injection Workshop
- III Adapter Workshop
- IV Testing Center
- V Mould and Tooling Workshop
- VI Mould Workshop EDM Machines

Optical Fiber Connector Series

LC Series Connector Exploded Views

LC 0.9/2.0DX/3.0

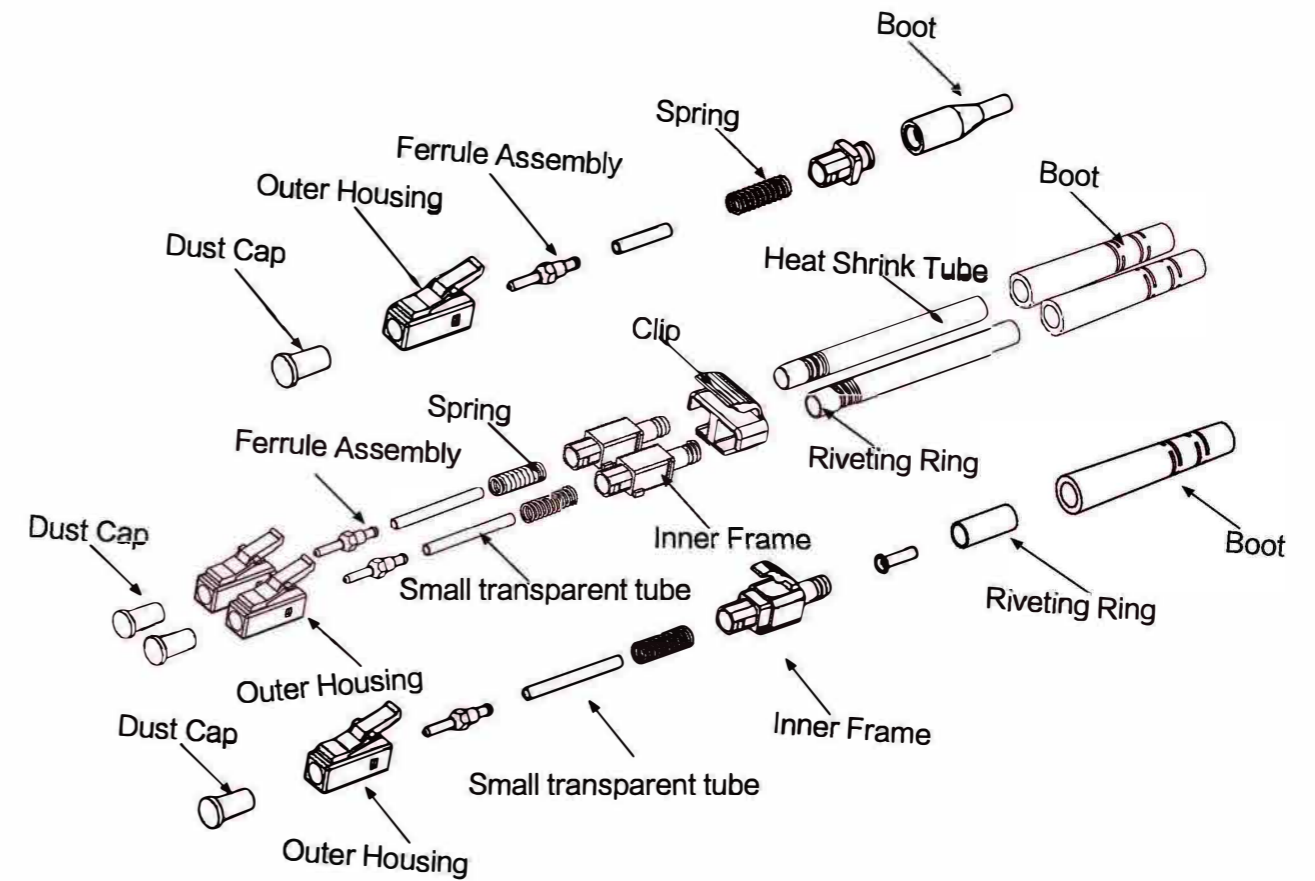

LC Series Selection table

Model	Color of housing	Color of boot	Color of Duplex clip (optional)	Fiber cable	Ferrule
LC	LC/UPC(Blue)	LC/UPC(Blue)	LC/UPC(Blue)	Φ0.9mm Φ1.2mm Φ2.0mm Φ3.0mm	Ceramic SM UPC Ceramic SM APC Ceramic MM PC
	LC/APC(Green)	LC/APC(Green)	LC/APC(Green)		
	MM(Beige)	MM(Beige)	MM(Beige)		
	OM3(Aqua)	OM3(Aqua)	OM3(Aqua)		
	OM4(Violet)	OM4(Violet)	OM4(Violet)		
	OM5(Lemon Green)	OM5(Lemon Green)	OM5(Lemon Green)		

Colours can be customized

1	2	3	4	5	6
Blue	Green	Beige	Aqua	Violet	Lemon Green

LC Series
Fiber optic connector



LC Series
Fiber optic connector



LC Series
Fiber optic connector



LC Series
Fiber optic connector

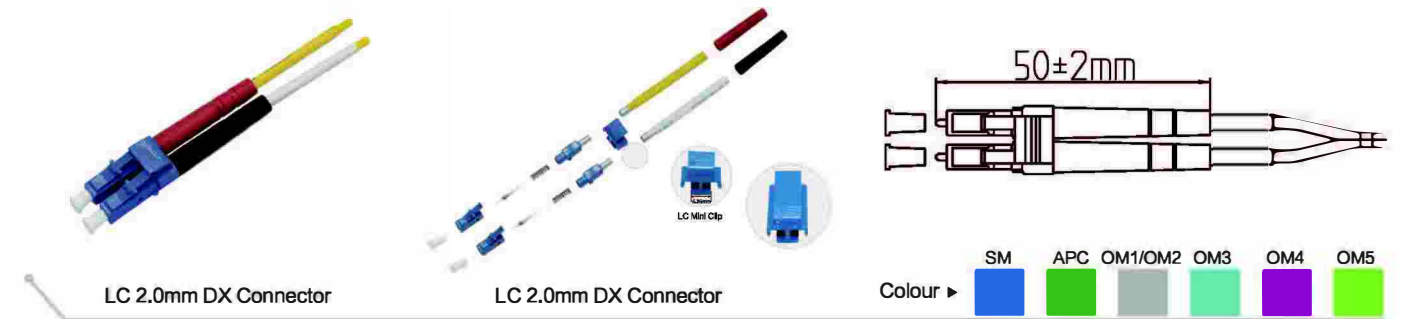

LC Series
Fiber optic connector



LC Series
Fiber optic connector

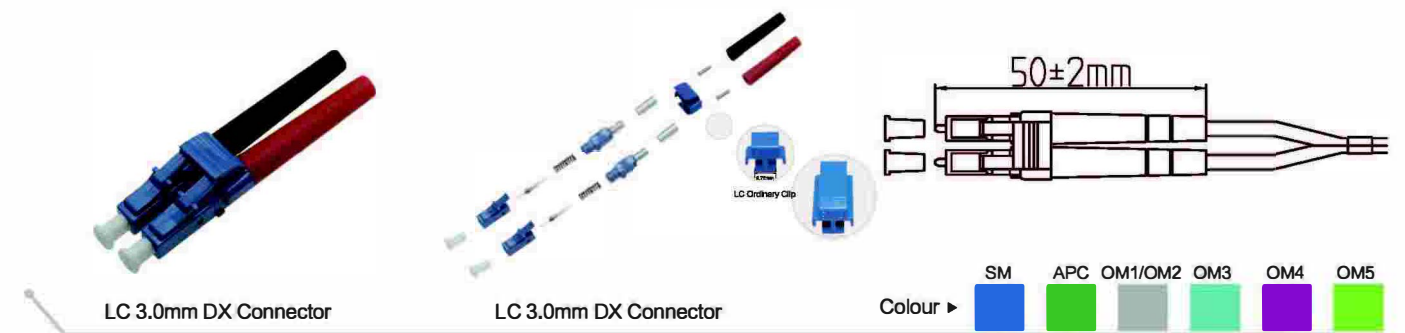

UNIBOOT Series
Fiber optic connector

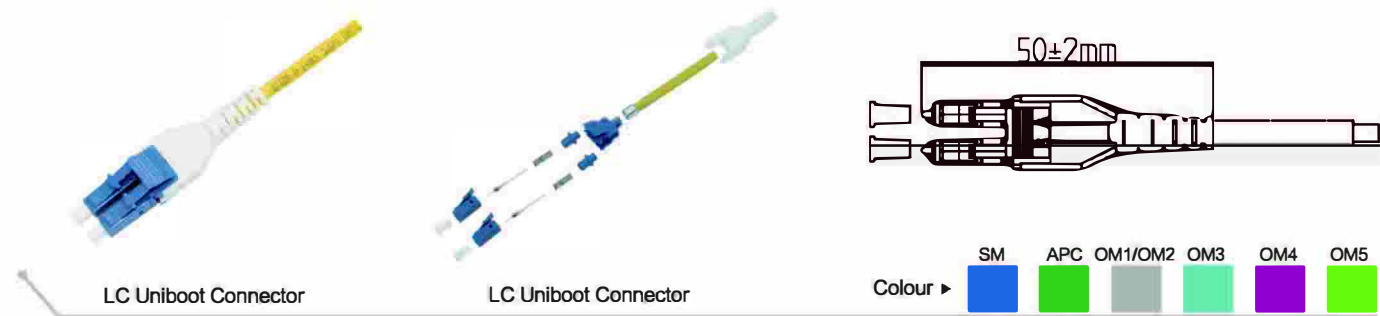

UNIBOOT Series
Fiber optic connector



UNIBOOT Series
Fiber optic connector

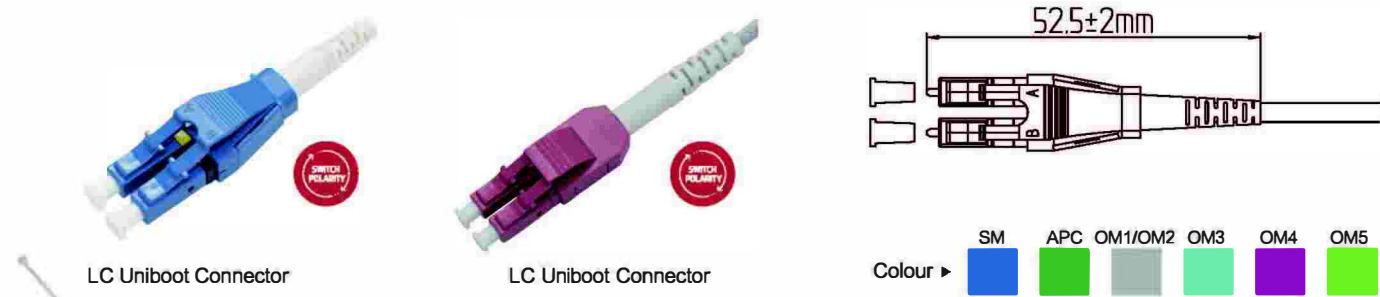

LC Series
Fiber optic connector Boot

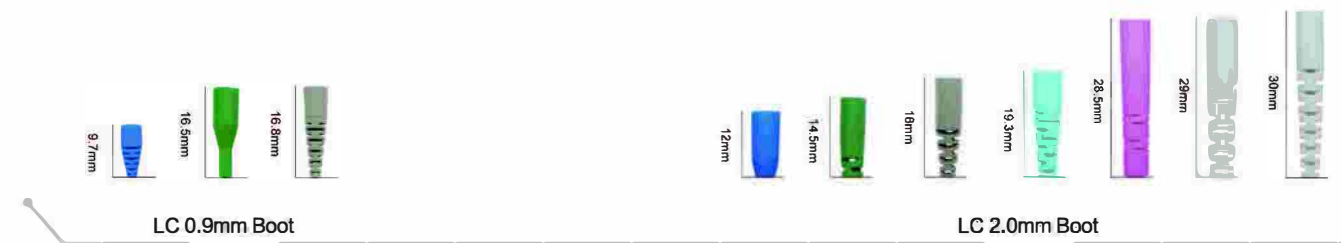

LC Series
Fiber optic connector Boot

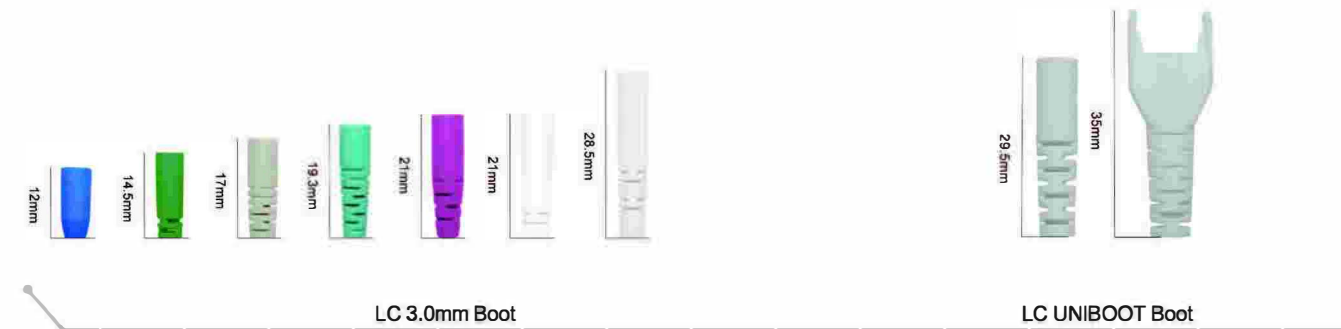

LC Dust Cap/Ferrule



SC Series Connector Exploded Views

SC 0.9 SC 2.0/3.0

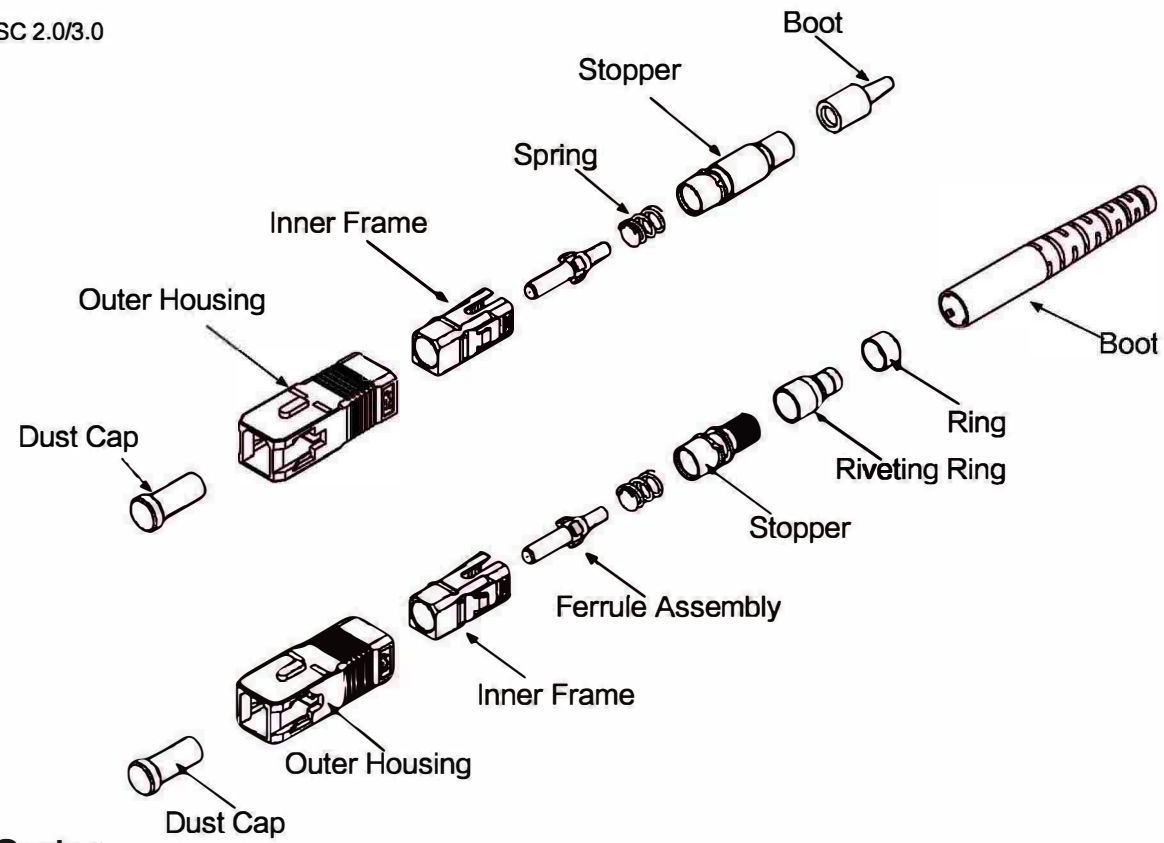

SC Series Selection table

Model	Color of housing	Color of boot	Color of Duplex clip (optional)	Fiber cable	Ferrule
SC	SC/UPC(Blue)	SC/UPC(Blue)	SC/UPC(Blue)	Φ0.9mm	Ceramic SM UPC Ceramic SM APC Ceramic MM PC
	SC/APC(Green)	SC/APC(Green)	SC/APC(Green)	Φ1.2mm	
	OM1/OM2(Beige)	OM1/OM2(Beige)	OM1/OM2(Beige)	Φ2.0mm	
	OM3(Aqua)	OM3(Aqua)	OM3(Aqua)	Φ3.0mm	
	OM4(Violet)	OM4(Violet)	OM4(Violet)	Φ3.5mm	
	OM5(Lemon Green)	OM5(Lemon Green)	OM5(Lemon Green)	Φ4.5mm	

Available in 12 colours:(Can be customized)

No	1	2	3	4	5	6	7	8	9	10	11	12
Colour	Blue	Orange	Green	Brown	Grey	White	Red	Black	Yellow	Violet	Pink	Aqua

SC Series SC Connector

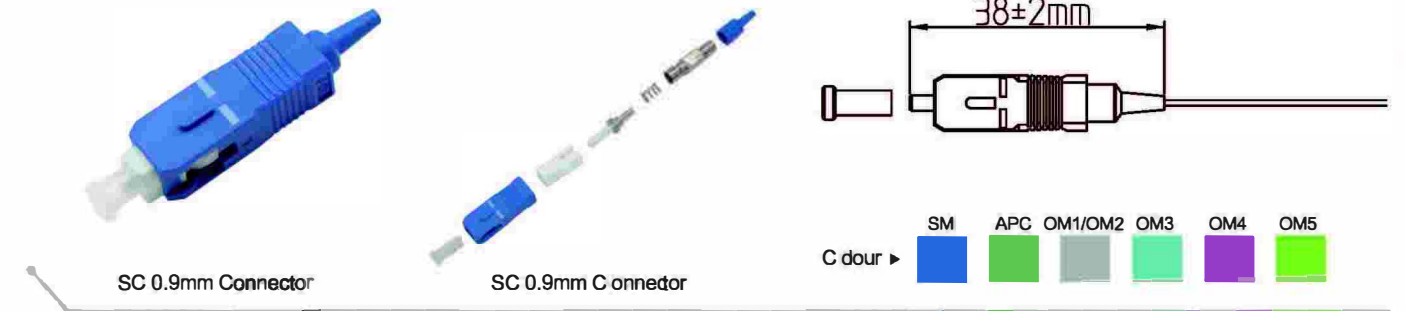

SC Series SC Connector

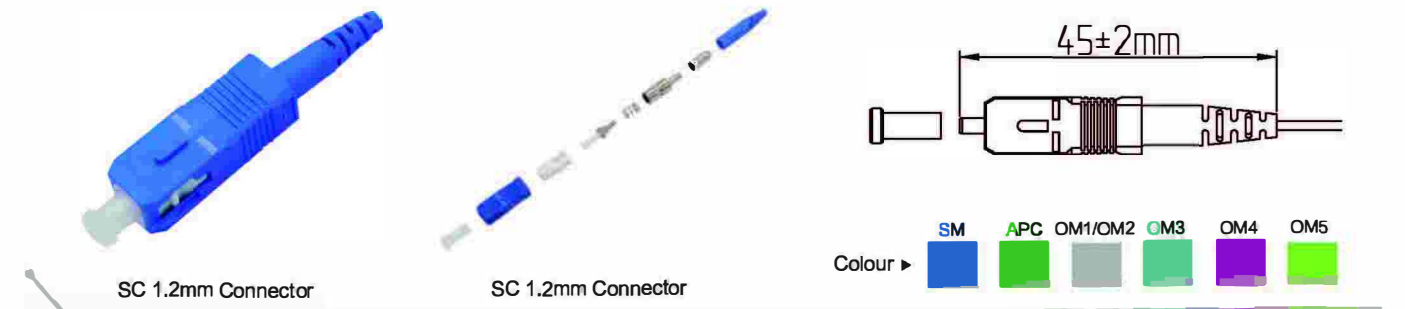

SC Series SC Connector

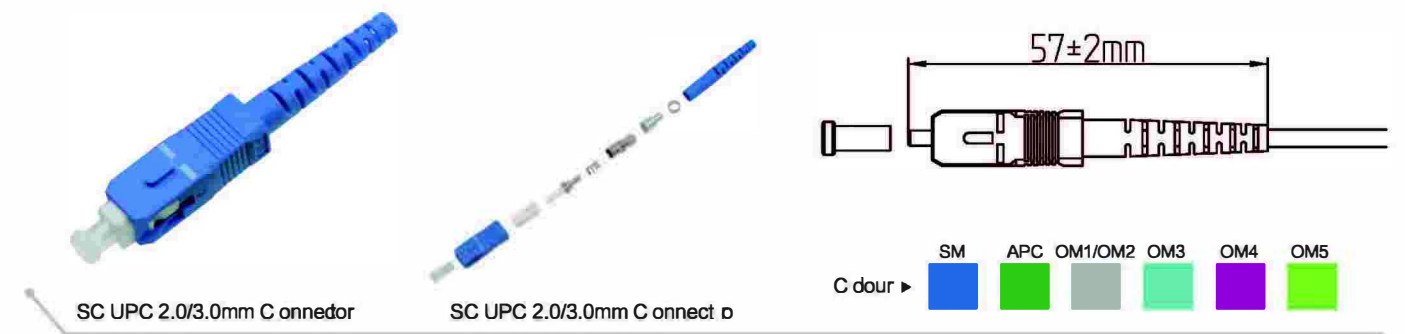

SC Series
SC Connector

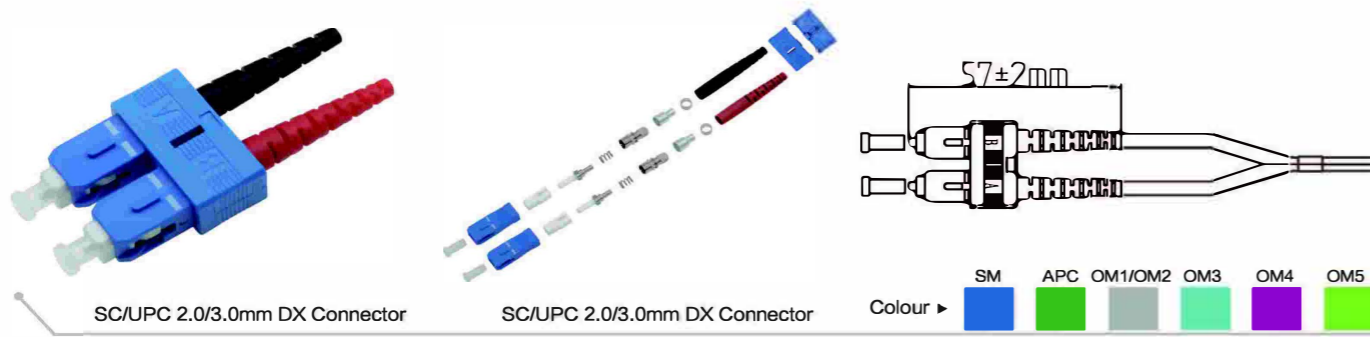

SC Series
SC Connector



SC Series
SC Connector Boot

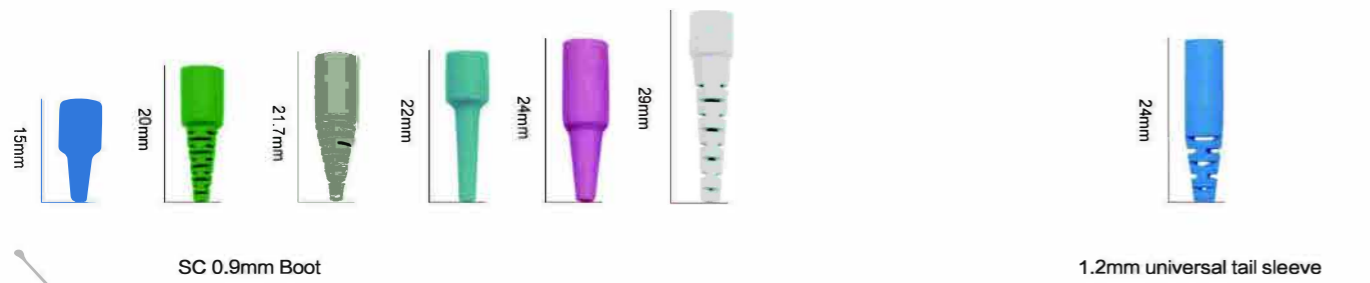

SC Series
SC Connector Boot

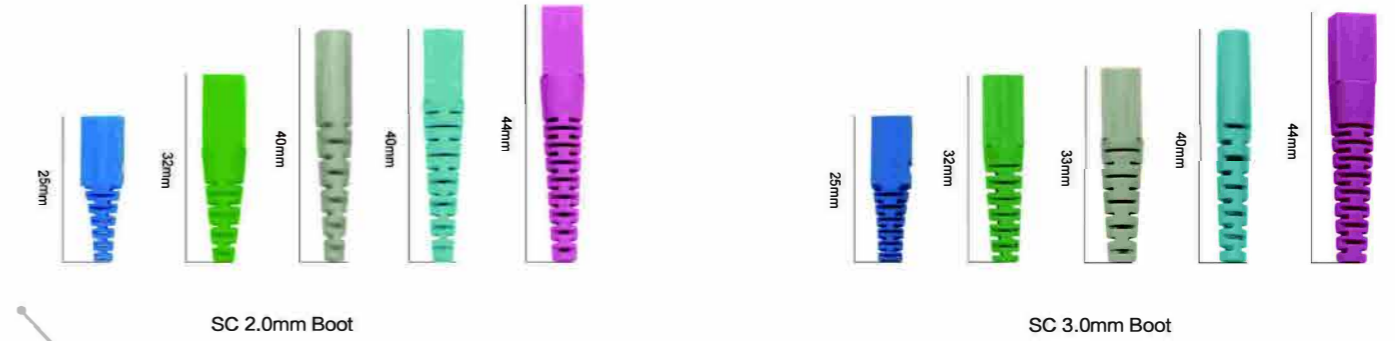

SC Dust Cap/Ferrule



SC Fiber Optic Connector
/Performance Parameter Table

Items	Ferrules	Inner diameter of ferrules	Ferrules Concentricity	Insertion loss	Return loss	Working temperature	Storage temperature
SM	UPC	125.3~126.3μm	<1.0μm	@1310/1550nm≤0.2dB	≥50dB	-40~+85°C	-40~+85°C
	APC		<0.5μm <0.3μm		≥60dB		
MM	PC	125.5~126.5μm	<4.0μm	@850/1300nm≤0.2dB	≥30dB		

FC Series Connector Exploded Views

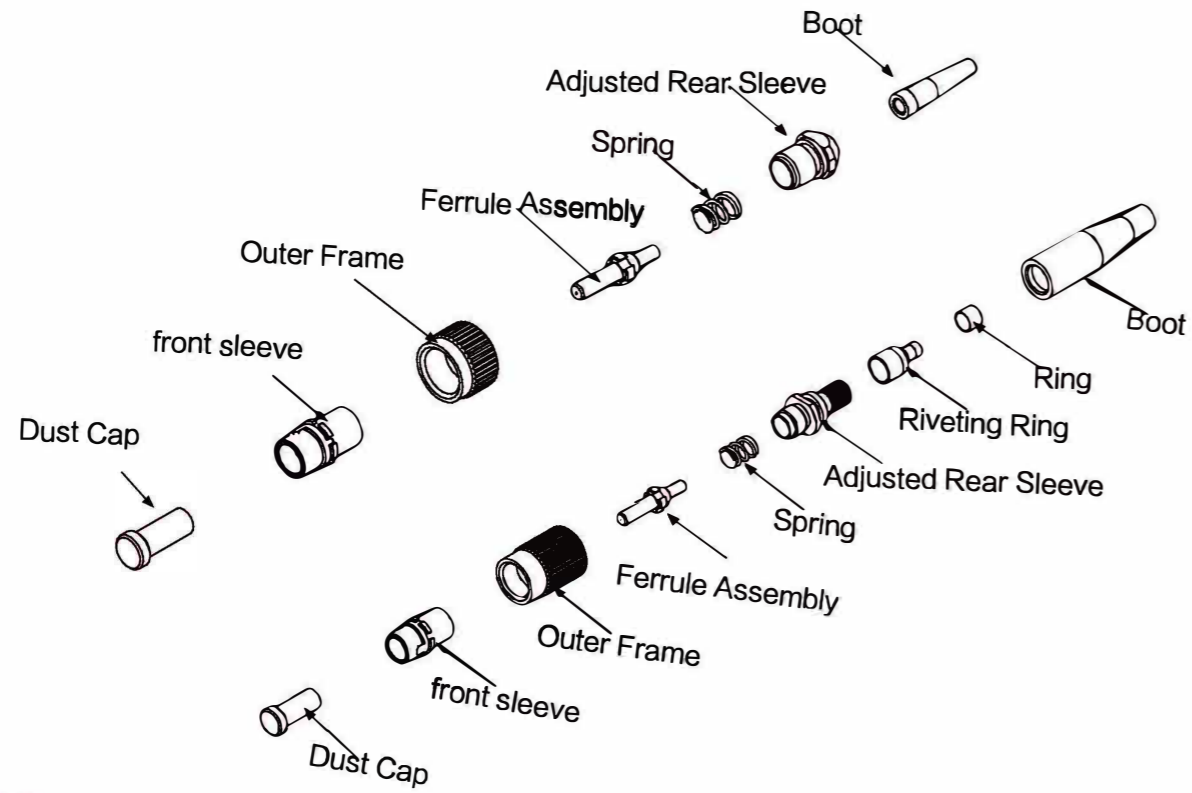

FC Series Selection table

Model	Color of boot	Fiber cable	Ferrule
FC	SM/UPC(Blue)	φ0.9mm φ2.0mm φ3.0mm	Ceramic SM UPC
	SM/APC(Green)		Ceramic SM APC
	MM(Beige)		Ceramic MM PC
	OM3(Aqua)		
	OM4(Violet)		

Available in 12 colours:(Can be customized)

No	1	2	3	4	5	6	7	8	9	10	11	12
Colour	Blue	Orange	Green	Brown	Grey	White	Red	Black	Yellow	Violet	Pink	Aqua

FC Series FC Connector



FC Series FC Connector



FC Series FC Connector Boot

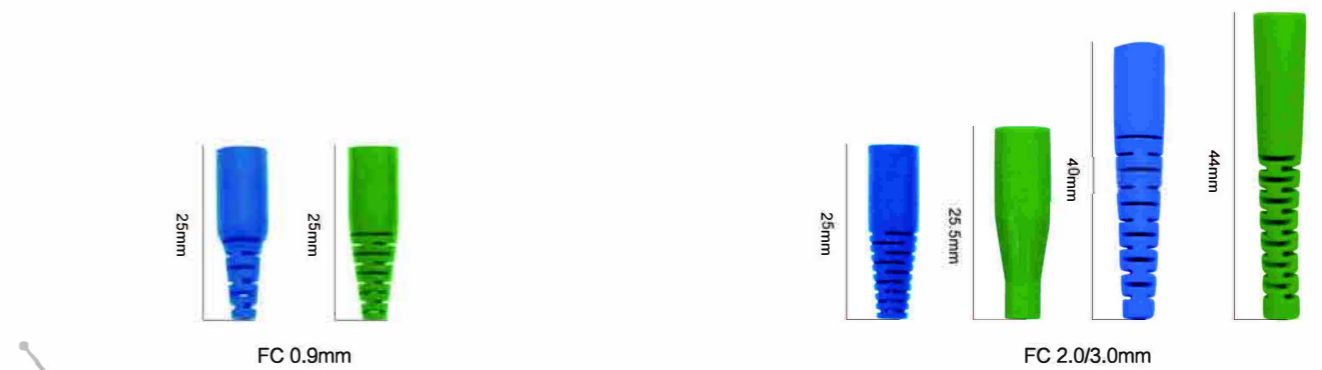

ST Series Connector Exploded Views

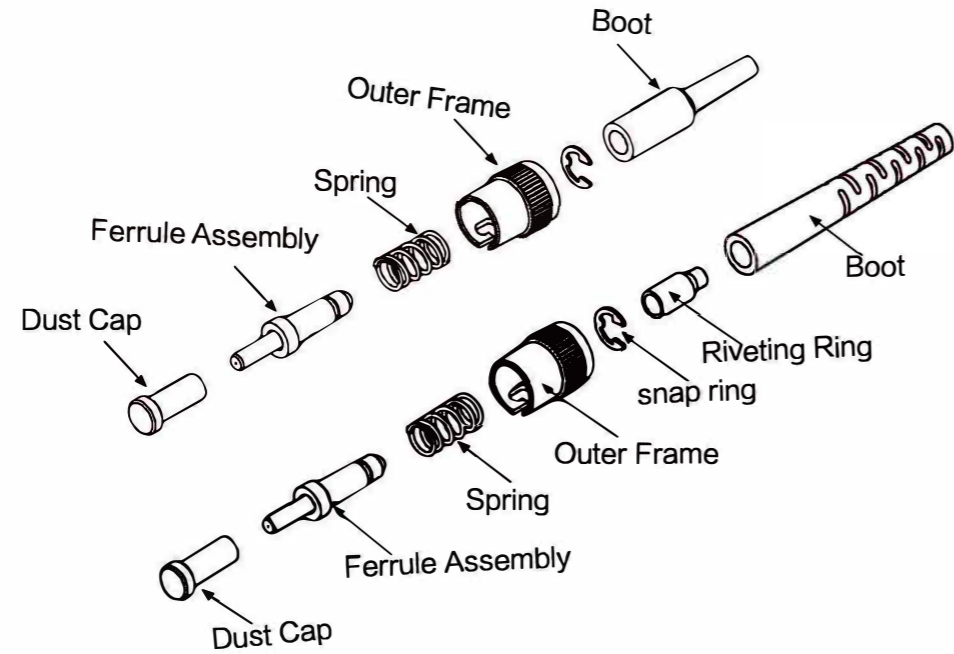

ST Series Selection table

Model	Color of boot	Fiber cable	Ferrule
ST	SM/UPC(Blue)	Φ0.9mm Φ2.0mm Φ3.0mm	Ceramic SM UPC
	SM/APC(Green)		Ceramic SM APC
	MM(Beige)		Ceramic MM PC
	OM3(Aqua)		
	OM4(Violet)		

Available in 12 colours:(Can be customized)

No	1	2	3	4	5	6	7	8	9	10	11	12
Colour	Blue	Orange	Green	Brown	Grey	White	Red	Black	Yellow	Violet	Pink	Aqua

ST Series Fiber optic connector

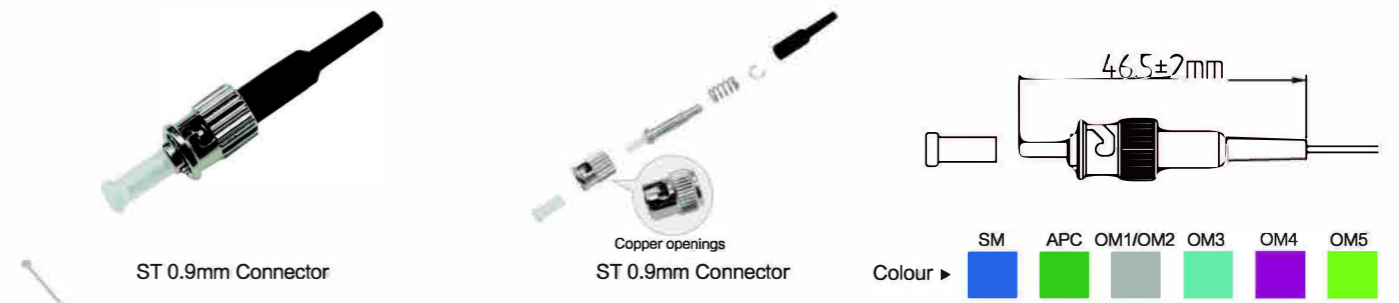

ST Series Fiber optic connector



ST Series ST Connector Boot

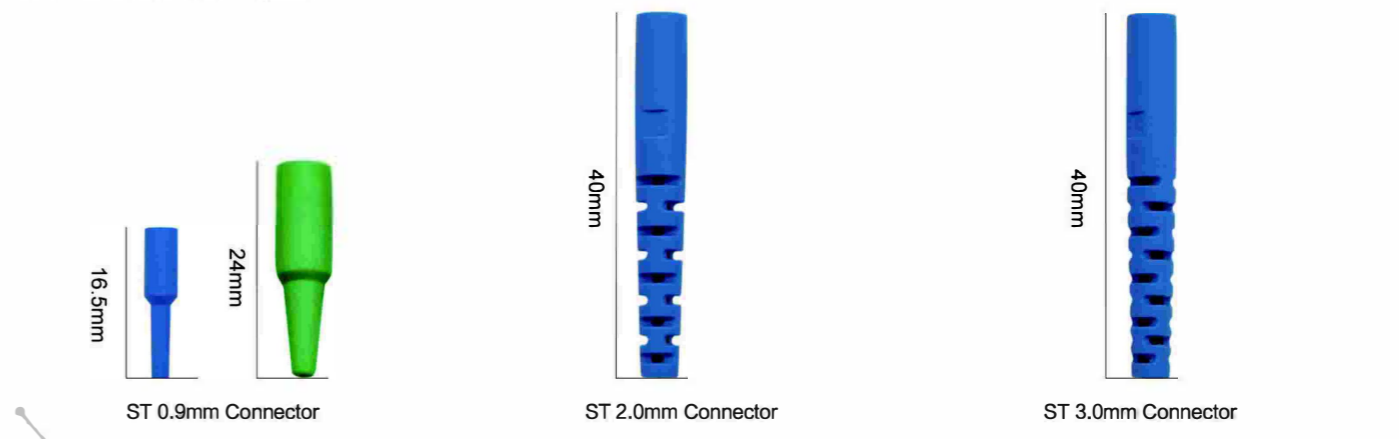

MU
Series Connector



MU 0.9mm Connector



MU 0.9mm Connector

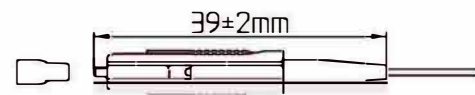

MU 0.9mm Connector

MTRJ
Series Connector



MTRJ Connector

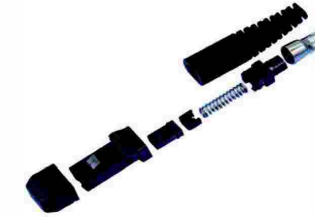

MTRJ Connector

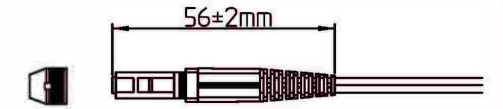

MTRJ Connector

MU
Series Connector



MU 2.0mm Connector



MU 2.0mm Connector

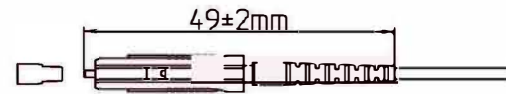

MU 2.0mm Connector



MTRJ
Series Adapter



MTRJ Adapter

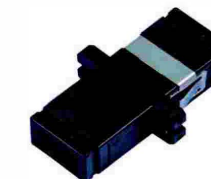

MTRJ Adapter

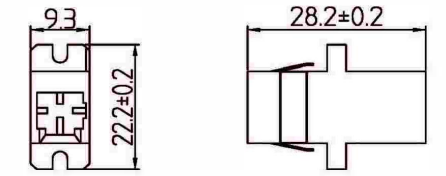

MTRJ Adapter

MU
Series Adapter



MU Adapter



MU Adapter

E2000
Series Connector



E2000 0.9mm Connector



E2000 0.9mm Connector

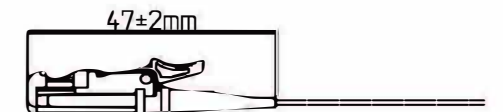

E2000 0.9mm Connector

E2000
Series Connector

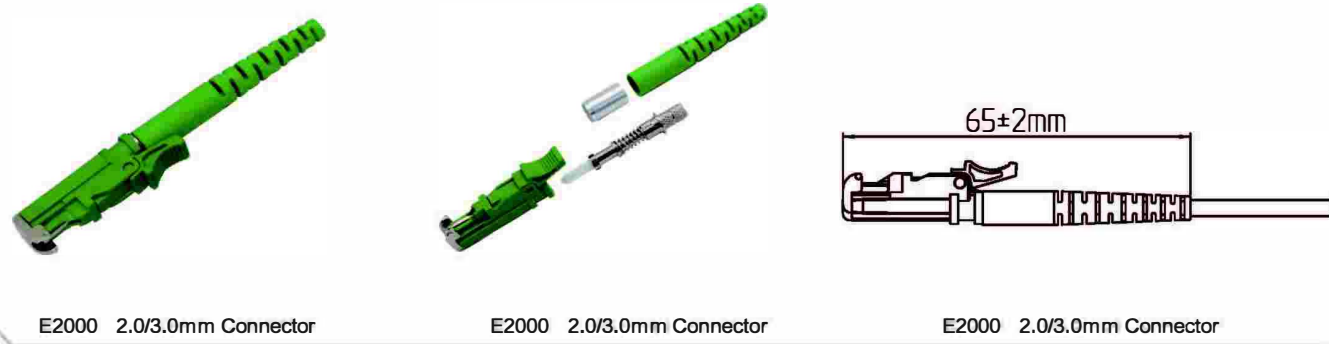

E2000 Series
Adaptor

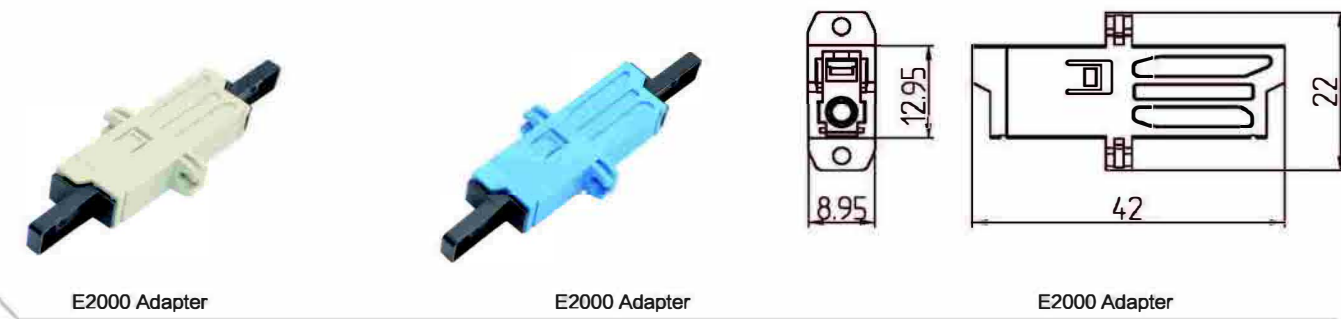

MPO
Series Connector

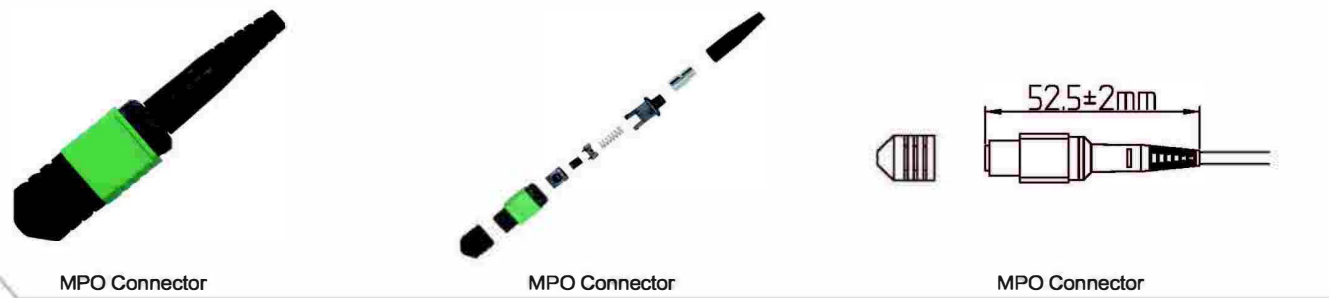

MPO
Series Connector

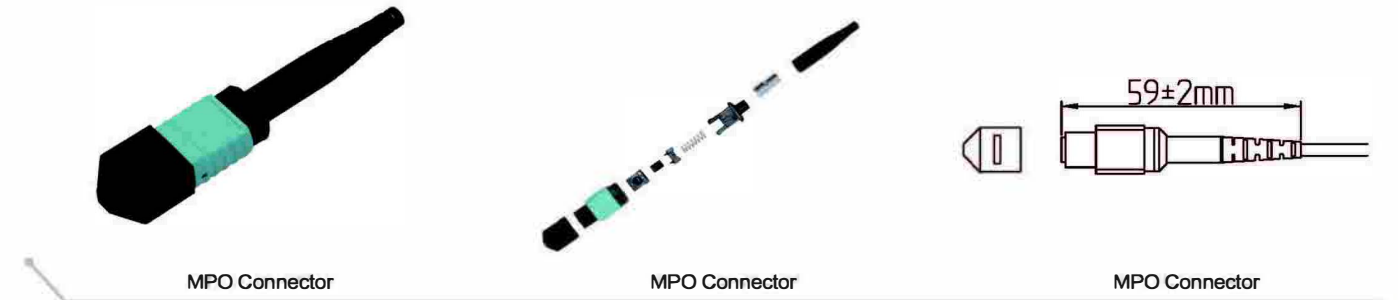

FAST Field
Connector

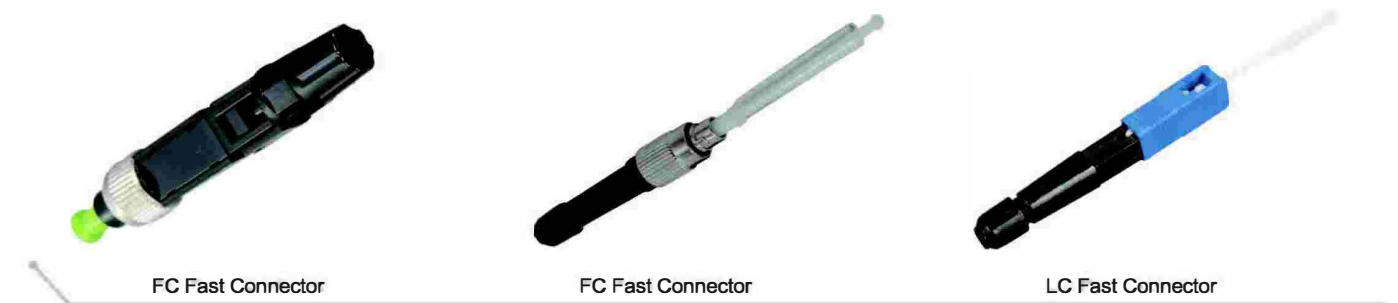

FAST Field
Connector



Optical Adapter

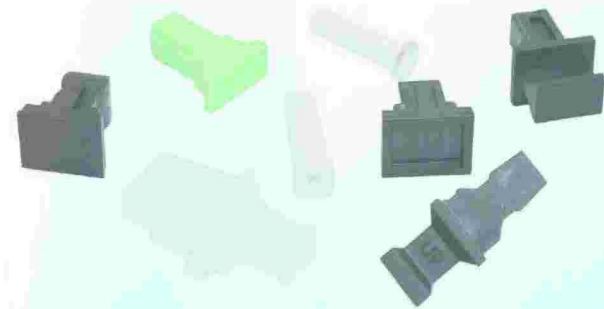

SC Series Adaptor

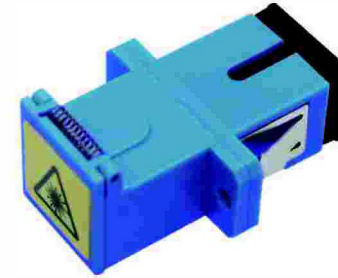

SC Front Shutter Avoid Laser Adapter With Flange



SC Front Shutter Avoid Laser Adapter With Flange

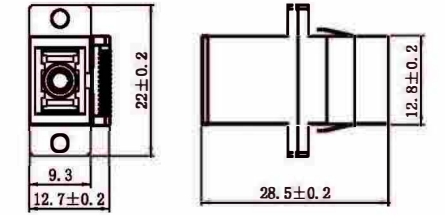

SC Front Shutter Avoid Laser Adapter With Flange

SC Series Adaptor



SC Front Shutter Avoid Laser Adapter Without Flange



SC Front Shutter Avoid Laser Adapter Without Flange

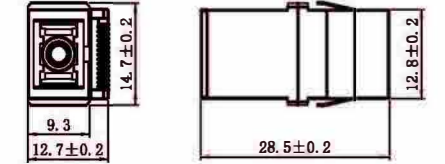

SC Front Shutter Avoid Laser Adapter Without Flange

SC Series Adaptor



SC Cover Avoid Laser Adapter Without Flange



SC Cover Avoid Laser Adapter Without Flange

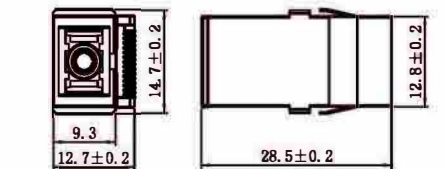

SC Cover Avoid Laser Adapter Without Flange

SC Series
Adaptor

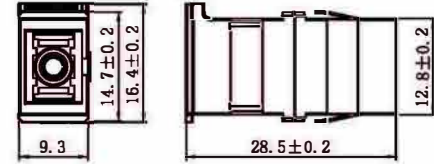

SC Side Shutter Avoid Laser Adapter Without Flange

SC Side Shutter Avoid Laser Adapter Without Flange

SC Side Shutter Avoid Laser Adapter Without Flange

SC Series
Adaptor

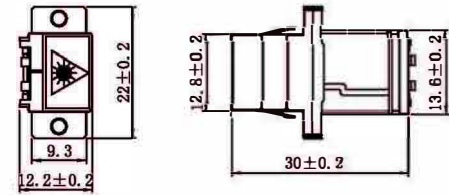
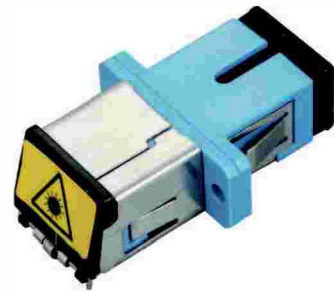

SC SX Metal Avoid Laser Adapter With Flange

SC SX Metal Avoid Laser Adapter With Flange

SC SX Metal Avoid Laser Adapter With Flange

SC Series
Adaptor

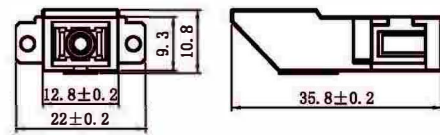

SC Inner Shutter Adapter With Flange

SC Inner Shutter Adapter With Flange

SC Inner Shutter Adapter With Flange

SC Series
Adaptor

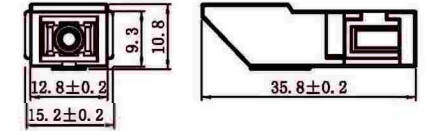

SC Inner Shutter Adapter Without Flange

SC Inner Shutter Adapter Without Flange

SC Inner Shutter Adapter Without Flange

SC Series
Adaptor

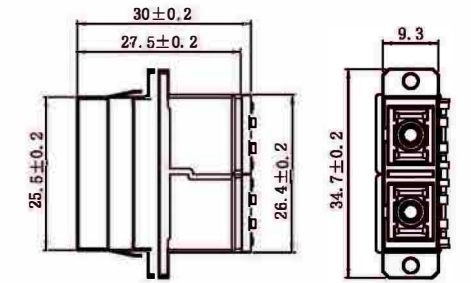

SC DX Metal Avoid Adapter With Flange

SC DX Metal Avoid Adapter With Flange

SC DX Metal Avoid Adapter With Flange

Optical Adapter
/Performance Parameter Table

Parameter	SM			MM
	PC	UPC	APC	PC
Insertion loss	≤ 0.2dB	≤ 0.2dB	≤ 0.2dB	≤ 0.2dB
Alternating loss	≤ 0.2dB			
Repeatability	≤ 0.2dB			
Durability	The change of 500 interpolation times is less than 0.20dB			
Working temperature	- 40°C ~ + 85°C			
Storage temperature	- 40°C ~ + 85°C			

LC Series Adaptor

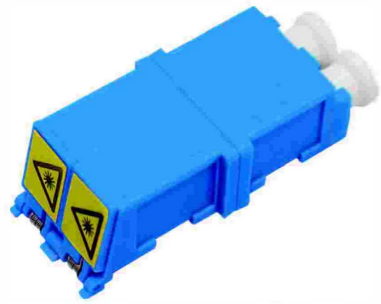

LC DX Avoid Laser Adapter Without Flange

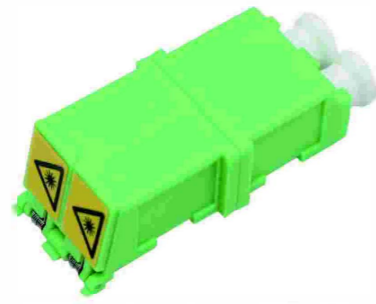

LC DX Avoid Laser Adapter Without Flange

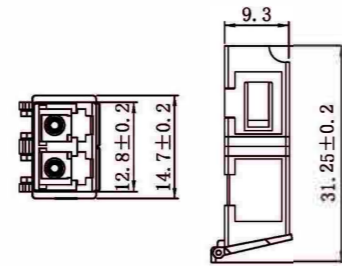

LC DX Avoid Laser Adapter Without Flange

LC Series Adaptor

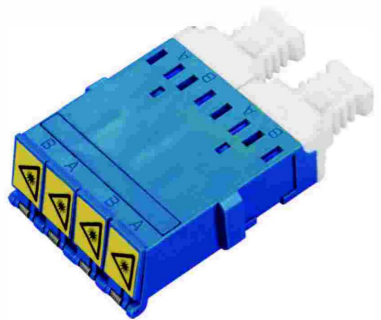

LC QUAD Avoid Laser Adapter Without Flange



LC QUAD Avoid Laser Adapter Without Flange

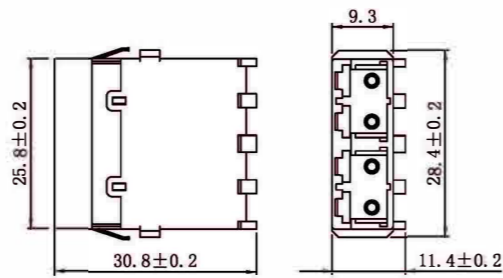

LC QUAD Avoid Laser Adapter Without Flange

Optical Adaptor Performance Parameter Table

Parameter	SM			MM
	PC	UPC	APC	PC
Insertion loss	≤ 0.2dB	≤ 0.2dB	≤ 0.2dB	≤ 0.2dB
Alternating loss			≤ 0.2dB	
Repeatability			≤ 0.2dB	
Durability	The change of 500 interpolation times is less than 0.20dB			
Working temperature	- 40°C ~ + 85°C			
Storage temperature	- 40°C ~ + 85°C			

Hybrid Series Adaptor

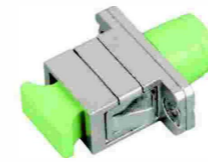

SC-FC SX Hybrid Adaptor

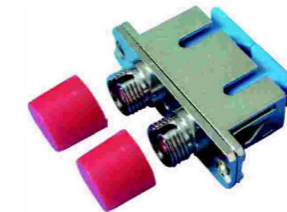

SC-FC DX Hybrid Adaptor

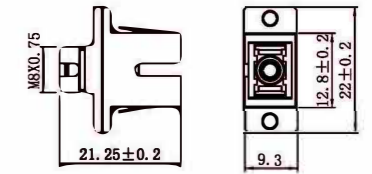

SC-FC SX Hybrid Adaptor

Hybrid Series Adaptor

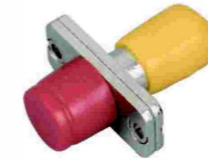

FC-ST SX Hybrid Adaptor



FC-ST DX Hybrid Adaptor

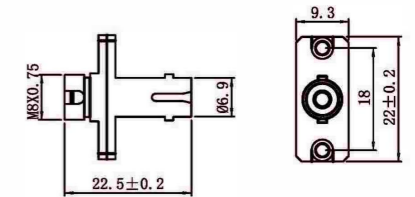

FC-ST SX Hybrid Adaptor

Hybrid Series Adaptor



SC-LC SX Hybrid Adaptor

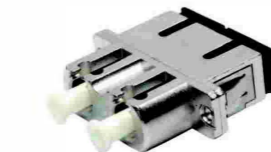

SC-LC DX Hybrid Adaptor

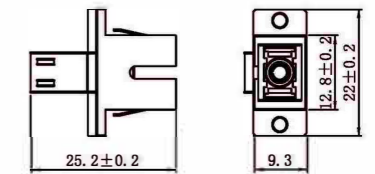

SC-LC SX Hybrid Adaptor

Hybrid Series Adaptor



SC-ST SX Hybrid Adaptor

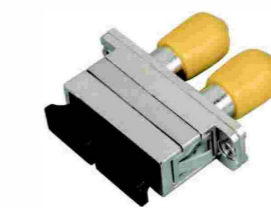

SC-ST DX Hybrid Adaptor

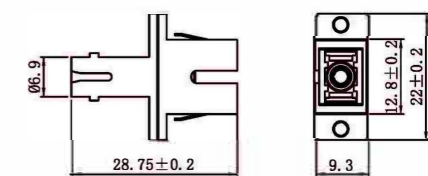

SC-ST SX Hybrid Adaptor

Optical Attenuator

SC Series Attenuator



SC/APC Attenuator 2dB



SC/APC Attenuator 5dB



SC/APC Attenuator 10dB

LC Series Attenuator



LC/UPC Attenuator 3dB



LC/UPC Attenuator 5dB



LC/APC Attenuator 7dB

FC Series Attenuator



FC Attenuator 3dB



FC Attenuator 7dB



FC Attenuator 5dB

ST Series Attenuator



ST Attenuator 3dB

Parameter	Unit	Value
Operating Wavelength	nm	1310/1550±10
Tolerance for 1-5dB Attenuation	dB	±0.5
Tolerance for 6-30dB Attenuation	nm	±10
Return Loss	dB	
Operating Temperature	°C	-40~+75
Polarization Dependent	dB	
Mating Durability	cycle	>1000

LC Series Adaptor

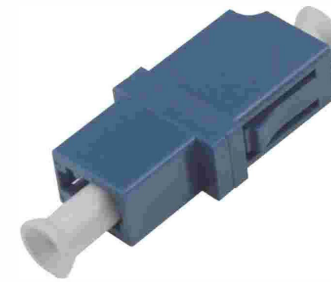

LC SX Adapter without Flange

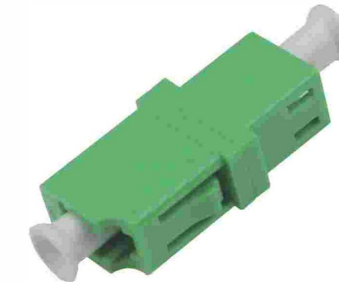

LC SX Adapter without Flange

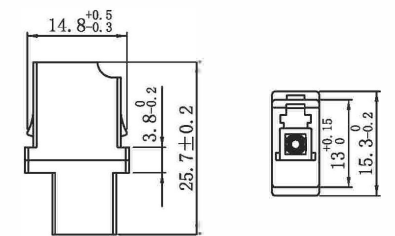

LC SX Adapter without Flange

LC Series Adaptor

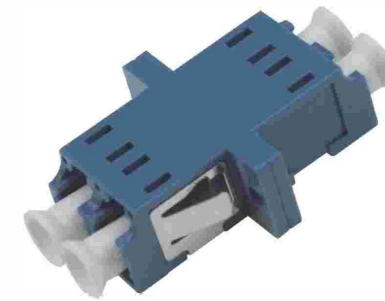

LC DX Welding Symmetry-type Adaptor With Flange

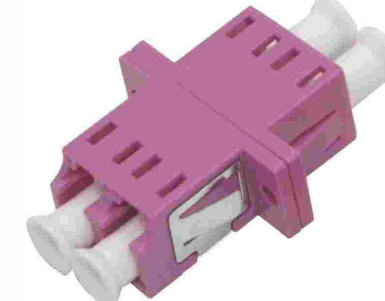

LC DX SC-type Welding Adaptor With Flange

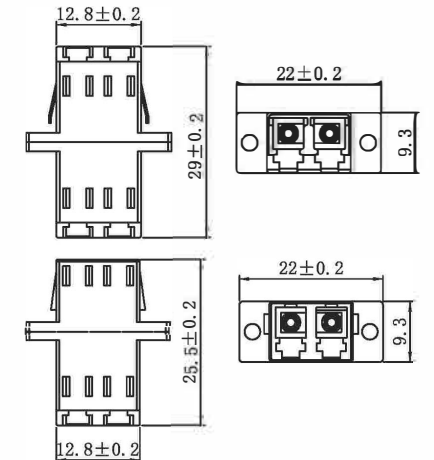

LC DX SC-type Welding Adaptor With Flange

LC Series Adaptor



LC DX Welding Symmetry-type Adaptor Without Flange

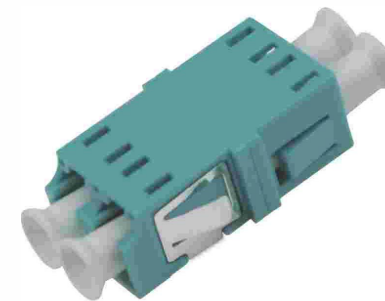

LC DX SC-type Welding Adaptor Without Flange

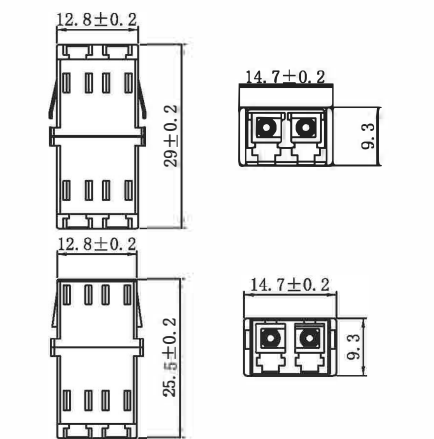

LC DX SC-type Welding Adaptor Without Flange

LC Series
Adaptor

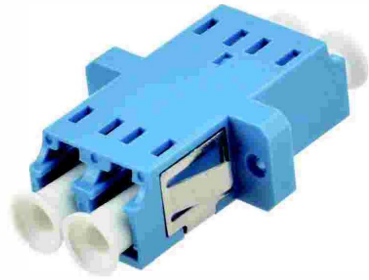

LC DX One-piece Adaptor With Flange

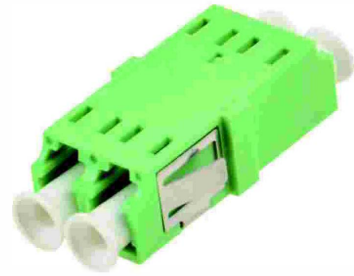

LC DX One-piece Adaptor Without Flange

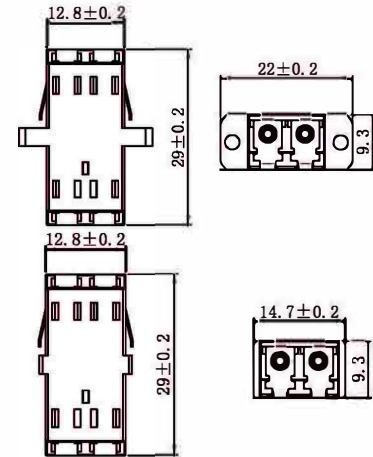

LC DX One-piece Adaptor Without Flange

LC Series
Adaptor

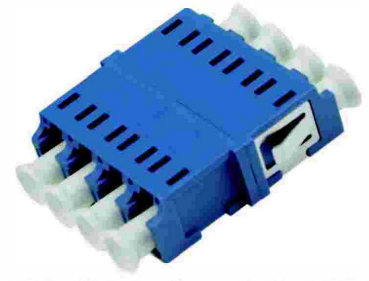

LC Quad Welding Symmetry-type Adaptor Without Flange

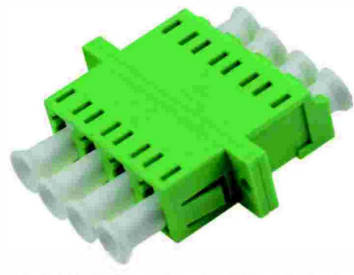

LC QUAD SC-type Welding Adaptor With Flange

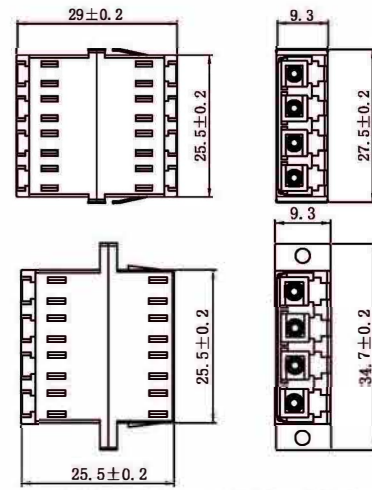

LC QUAD SC-type Welding Adaptor With Flange

LC Series
Adaptor

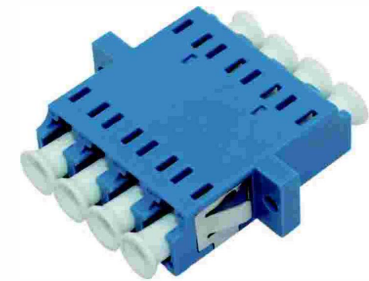

LC QUAD One-piece Adaptor With Flange

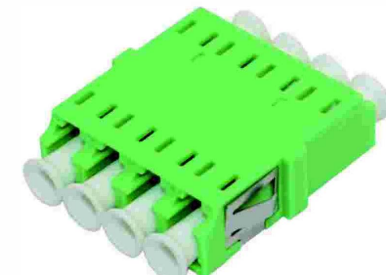

LC QUAD One-piece Adaptor Without Flange

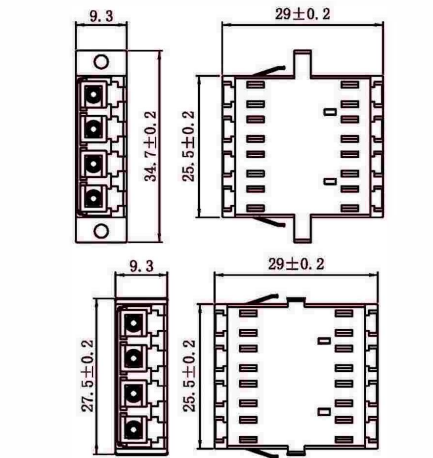

LC QUAD One-piece Adaptor Without Flange

LC Series
Adaptor

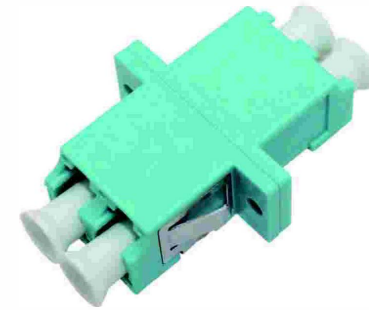

LC DX No skylight Adaptor

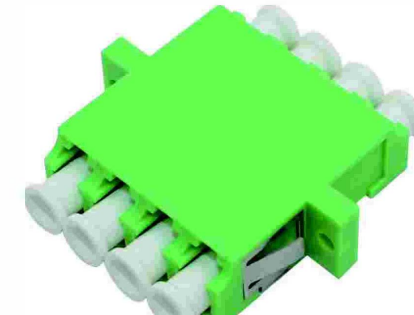

LC QUAD No skylight Adaptor

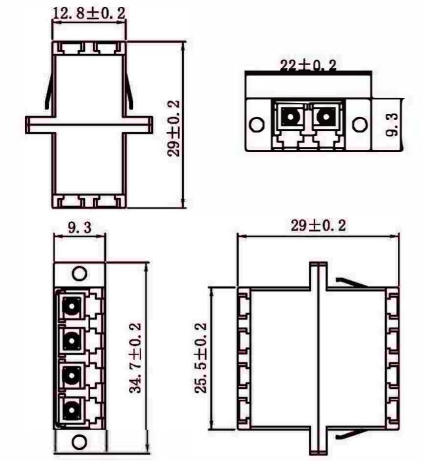

LC QUAD No skylight Adaptor

LC Series
Adaptor

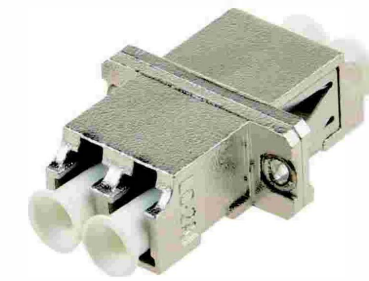

LC DX metal adaptor

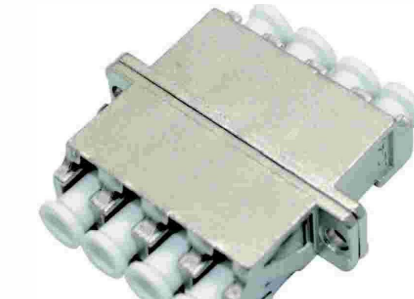

LC QUAD Metal Adaptor

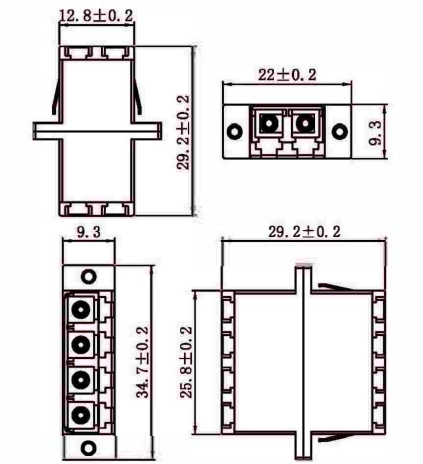

LC QUAD Metal Adaptor

LC Series
Adaptor



LC DX High-Low Adaptor

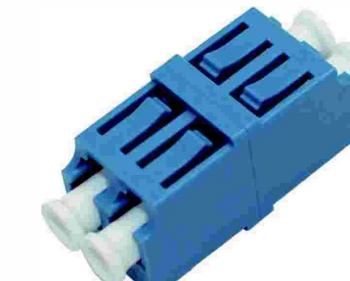

LC DX High-High Adaptor

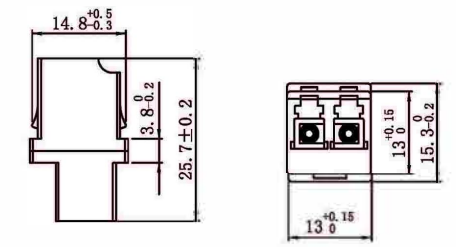

LC DX High-Low Adaptor

SC Series
Adaptor

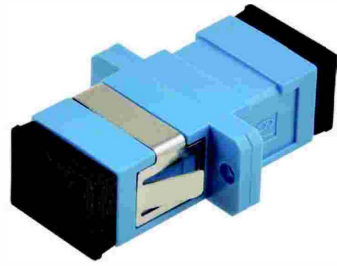

SC SX Welding Adapter With Flange

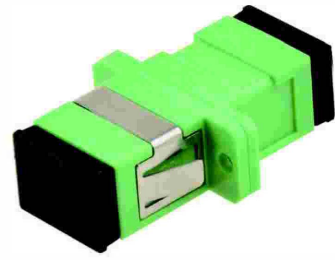

SC SX Welding Adapter With Flange

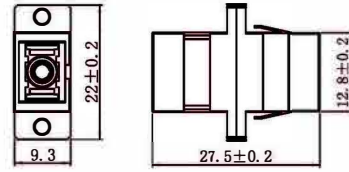

SC SX Welding Adapter With Flange

SC Series
Adaptor

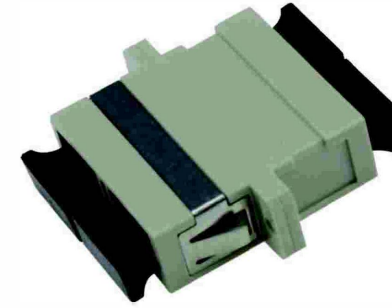

SC DX Welding Adapter With Flange

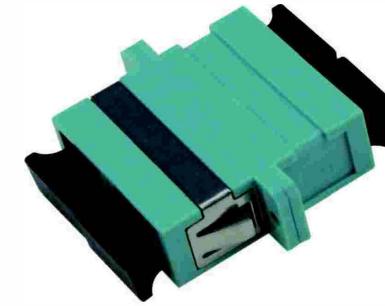

SC DX Welding Adapter With Flange

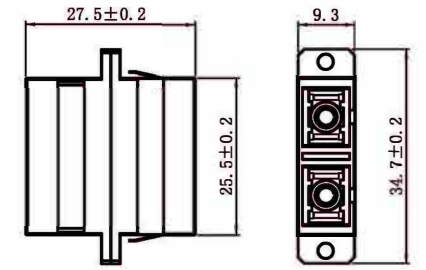

SC DX Welding Adapter With Flange

SC Series
Adaptor

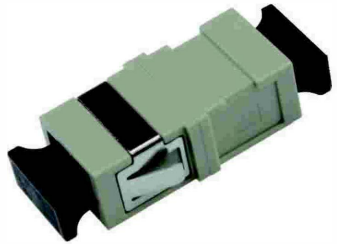

SC SX Welding Adapter Without Flange

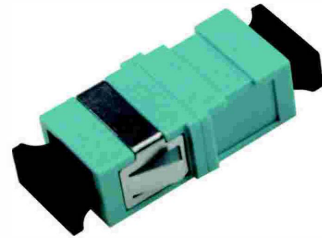

SC SX Welding Adapter Without Flange

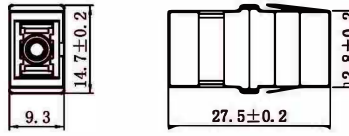

SC SX Welding Adapter Without Flange

SC Series
Adaptor



SC DX Welding Adapter Without Flange

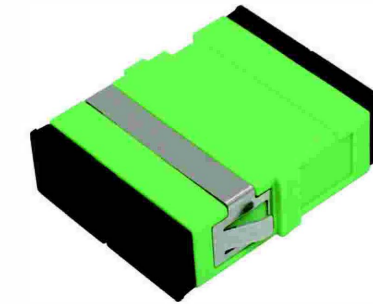

SC DX Welding Adapter Without Flange

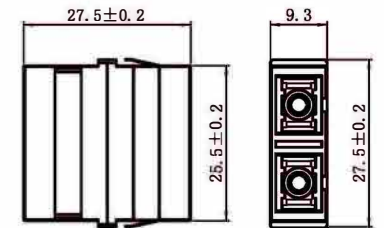

SC DX Welding Adapter Without Flange

SC Series
Adaptor

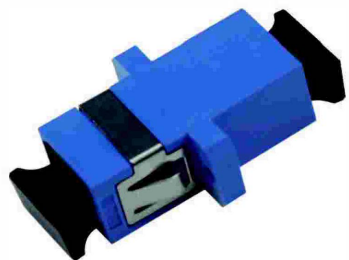

SC SX One-piece Adapter With Flange



SC SX One-piece Adapter Without Flange

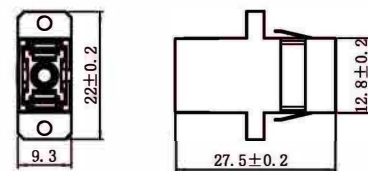

SC SX one-piece adapter with flange

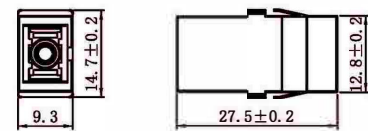

SC SX One-piece Adapter Without Flange

SC Series
Adaptor

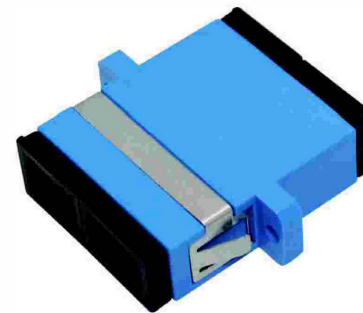

SC DX One-piece Adapter With Flange

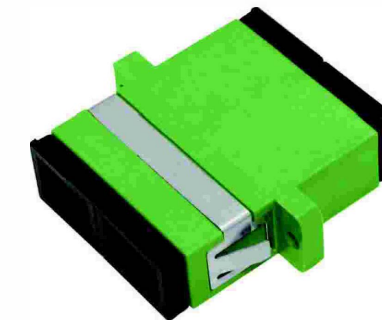

SC DX One-piece Adapter With Flange

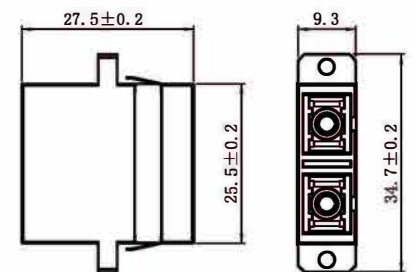

SC DX One-piece Adapter With Flange

SC Series
Adaptor

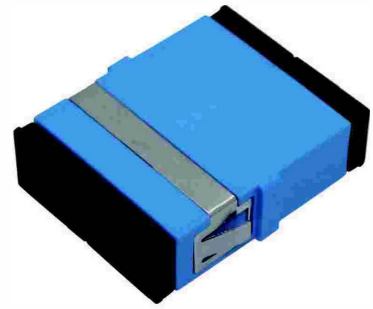

SC DX One-piece Adapter Without Flange

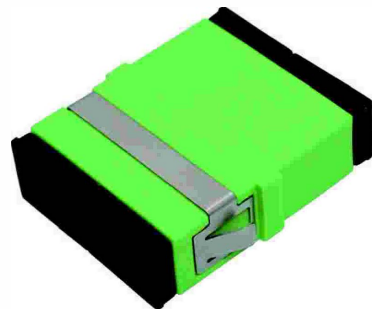

SC DX One-piece Adapter Without Flange

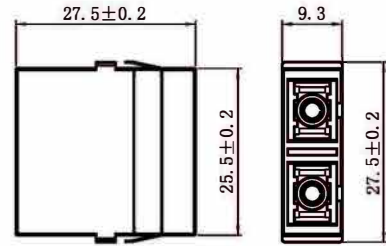

SC DX One-piece Adapter Without Flange

SC Series
Adaptor

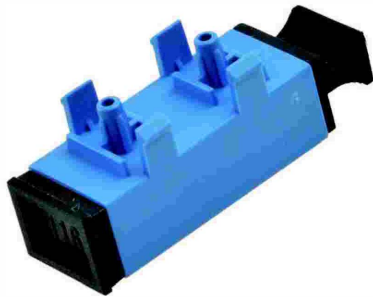

SC Adapter With Legs

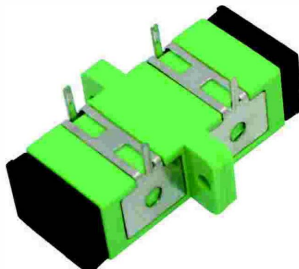

SC Shrapnel Adapter

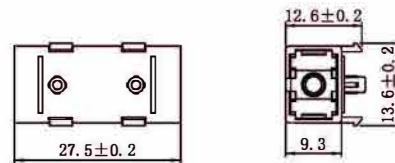

SC Adapter With Legs

SC Series
Adaptor

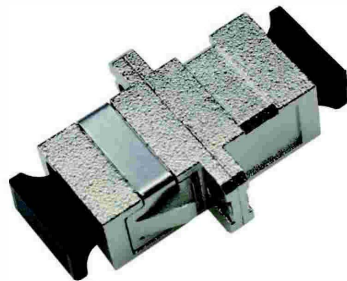

SC SX Metal Adapter

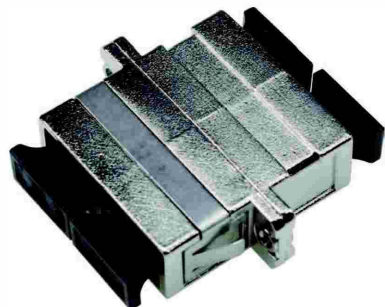

SC DX Metal Adapter

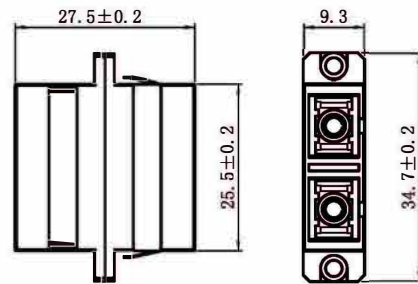

SC DX Metal Adapter

FC Series
Adaptor



FC SX big D-Type Adaptor



FC SX small D-Type Adaptor

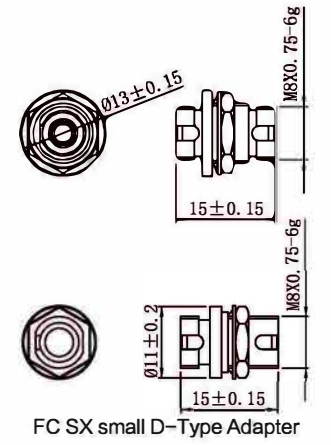

FC SX small D-Type Adaptor

FC Series
Adaptor



FC SX Adapter With Rectangle Flange

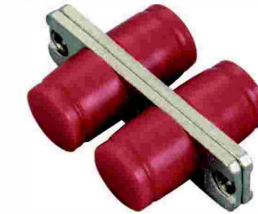

FC DX Adapter With Rectangle Flange

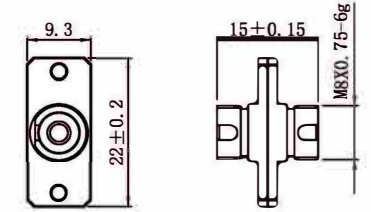

FC SX Adapter With Rectangle Flange

FC Series
Adaptor



FC Adapter With Square Flange



FC Adapter With Rectangle Flange

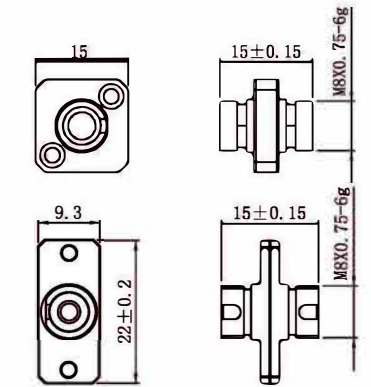

FC Adapter With Rectangle Flange

Optical Adaptor
/Performance Parameter Table

Parameter	SM			MM
	PC	UPC	APC	PC
Insertion loss	≤ 0.2dB	≤ 0.2dB	≤ 0.2dB	≤ 0.2dB
Alternating loss	≤ 0.2dB			
Repeatability	≤ 0.2dB			
Durability	The change of 500 interpolation times is less than 0.20dB			
Working temperature	- 40°C ~ + 85°C			
Storage temperature	- 40°C ~ + 85°C			

ST Series Adaptor



ST SX Metal Adaptor With Rectangle Flange

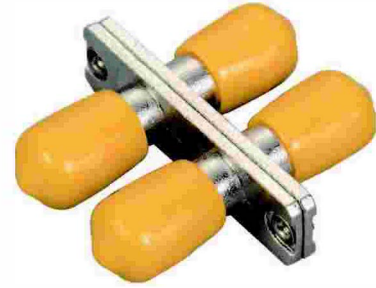

ST DX Metal Adaptor With Rectangle Flange

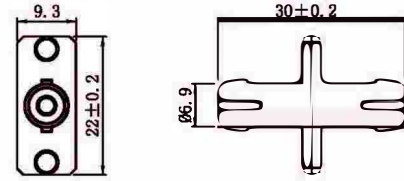

ST SX Metal Adaptor With Rectangle Flange

ST Series Adaptor



ST Adaptor

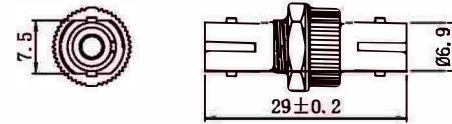

ST Adaptor

Optical Adapter /Performance Parameter Table

Parameter	SM			MM
	PC	UPC	APC	PC
Insertion loss	≤ 0.2dB	≤ 0.2dB	≤ 0.2dB	≤ 0.2dB
Alternating loss	≤ 0.2dB			
Repeatability	≤ 0.2dB			
Durability	The change of 500 interpolation times is less than 0.20dB			
Working temperature	- 40°C ~ + 85°C			
Storage temperature	- 40°C ~ + 85°C			

Optical Patch Cord

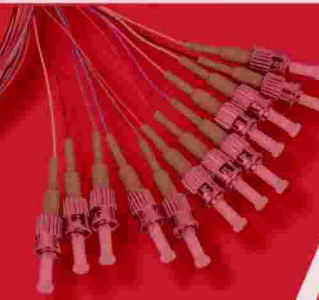

LC Uniboot Patch Cords

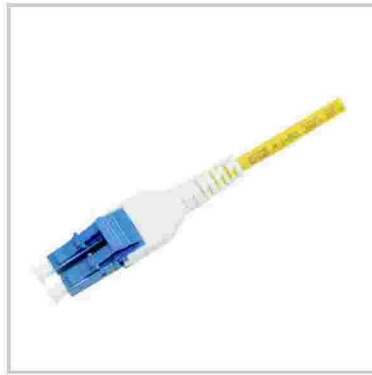

LC Uniboot Patch Cords



LC Uniboot Patch Cords



LC Uniboot Patch Cords

MU Patch Cords



MU Patch Cords



MU Patch Cords



MU Patch Cords

LC Uniboot Patch Cords



LC Uniboot Patch Cord with Rod



LC Uniboot Patch Cord with Rod



LC Uniboot Patch Cord with Rod

MTRJ Patch Cords



MTRJ Patch Cords



MTRJ Patch Cords



MTRJ Patch Cords

LC Uniboot Patch Cords



LC Uniboot Patch Cords



LC Uniboot Patch Cords



LC Uniboot Patch Cords

SMA Patch Cords

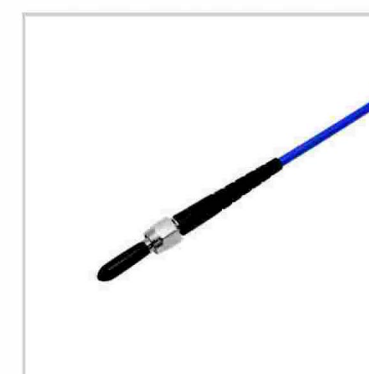

SMA Patch Cords



SMA Patch Cords



SMA Patch Cords

Optical Patch Cord

Optical Patch Cord

MPO Patch Cords



MPO Patch Cords

MPO Patch Cords

MPO Patch Cords

45° Bend Boot Patch Cords

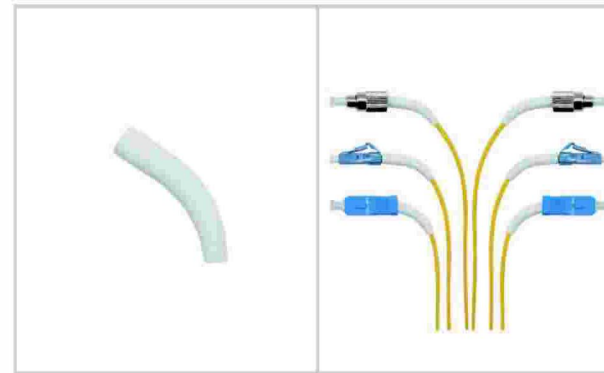

45° Bend Boot Patch Cords

90° Bend Boot Patch Cords

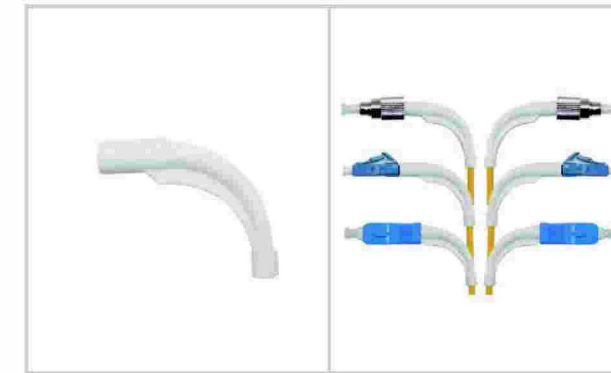

90° Bend Boot Patch Cords

Energy Fiber



energy fiber

waterproof cable



LC DX waterproof cable

CPRI cable



LC DX CPRI cable

SC Pigtail

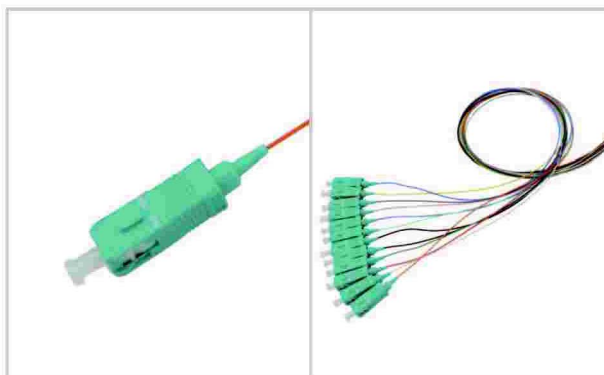

SC 12 Colors Pigtail

LC Pigtail

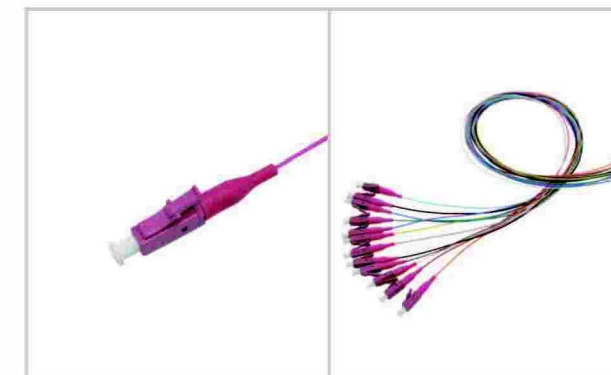

LC 12 Colors Pigtail

Optical Patch Cord
/Performance Parameter Table

Parameter	LC,FC,ST,MU,MT-RJ,E2000		
	SM	APC	MM
Insertion loss	≤ 0.2dB		≤ 0.2dB
Return loss	≥ 50dB	≥ 60dB	≥ 30dB
Working wavelength	SM@1310nm/1550nm		MM@850nm/1300nm
Alternating loss	≤ 0.2dB		
Repeatability	≤ 0.2dB		
Working temperature	- 40°C ~ + 85°C		
Storage temperature	- 40°C ~ + 85°C		
Cable diameter	Φ0.9,Φ1.2,Φ2.0,Φ3.0,Φ4.5		

Pigtail Performance
/Parameter Table

Parameter	LC,FC,ST,MU,MT-RJ,E2000		
	SM	APC	MM
Insertion loss	≤ 0.2dB		≤ 0.2dB
Return loss	≥ 50dB	≥ 60dB	≥ 30dB
Working wavelength	SM@1310nm/1550nm		MM@850nm/1300nm
Alternating loss	≤ 0.2dB		
Repeatability	≤ 0.2dB		
Working temperature	- 40°C ~ + 85°C		
Storage temperature	- 40°C ~ + 85°C		
Cable diameter	Φ0.9,Φ1.2,Φ2.0,Φ3.0,Φ4.5		

Optical Splitter

FBT Splitter

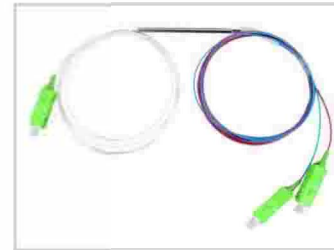

SC/APC Mini Tube FBT Splitter



SC/APC Mini Tube FBT Splitter

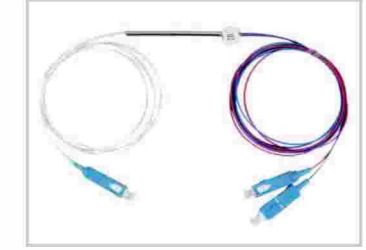

SC/PC Mini Tube FBT Splitter

LGX Type PLC Splitter

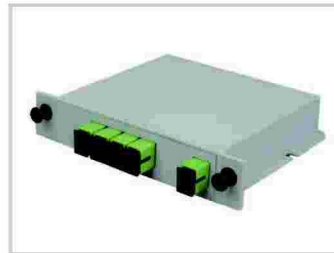

1 x 4 PLC Splitter

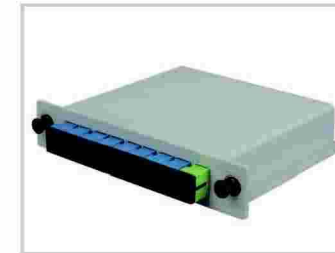

1 x 8 PLC Splitter



1 x 16 PLC Splitter

ABS Box Type PLC Splitter

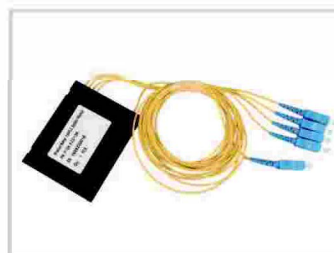

1 x 4 PLC Splitter



1 x 8 PLC Splitter

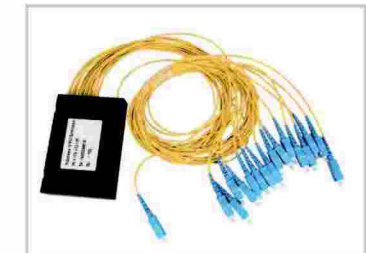

1 x 16 PLC Splitter

Mini Tube Type PLC Splitter



1 x 8 PLC Splitter With Connectors



1 x 16 PLC Splitter With Connectors

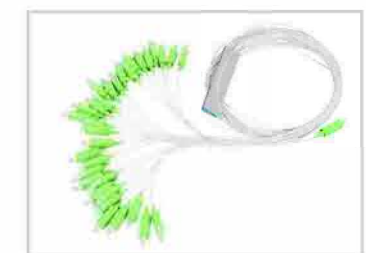

1 x 32 PLC Splitter With Connectors

Optical Splitter

Fiber Optic Accessories



Loop Back

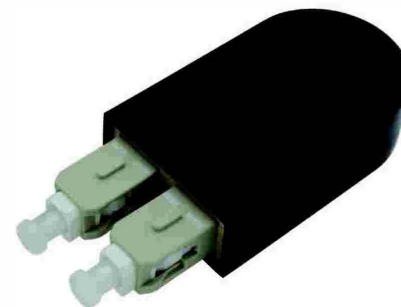

SC Loop Back

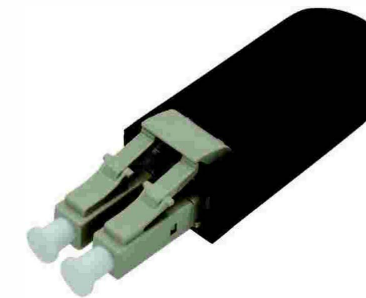

LC Loop Back

Branching Device of 12cores Ribbon Cable



Branching Device of 12cores Ribbon Cable



New Branching Device Of 12 Cores Ribbon Cable

Terminal Box Dust Cover

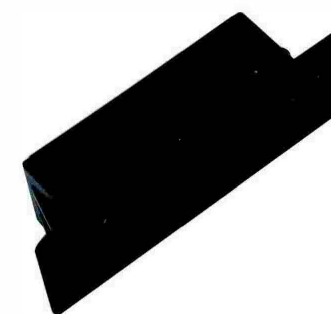

Terminal Box Dust Cover

Splicing Sleeve



Splicing Sleeve

FTTH Architecture

FTTH Architecture

FTTH Architecture



Wall Outlet Box

This mini Fiber Optic Socket Panel fiber optic termination box is used for splicing and termination between indoor fiber optic cable and pigtails with SC or LC duplex type. The termination box is used for wall mounted or desktop applications. Made of the plastic material, is easy to install in home or office. Outlets are designed to fit SC fiber optic cable patch cord adapter, used in work location subsystem.



WOT-YF1C-A01

Technical Features

Technical Parameter

- Connector attenuation (insert, interchange, repeat) $\leq 0.2\text{dB}$.
- Return loss: APC $\geq 60\text{dB}$, UPC $\geq 50\text{dB}$.
- During maintenance, clear marking of the optical path could avoid confusion effectively.
- Connector plug durability > 1000 times.

Dimensions and Capacity	
Dimensions (H*W*D)	117mm*86mm*23mm
Weight	80g
Adapter Type	SC Simplex/LC Duplex
Adapter Capacity	1pcs
Working Temperature	-40°C~+65°C

Wall Outlet Box

This mini Fiber Optic Socket Panel fiber optic termination box is used for splicing and termination between indoor fiber optic cable and pigtails with SC or LC duplex type. The termination box is used for wall mounted or desktop applications. Made of the plastic material, is easy to install in home or office. Outlets are designed to fit SC fiber optic cable patch cord adapter, used in work location subsystem.

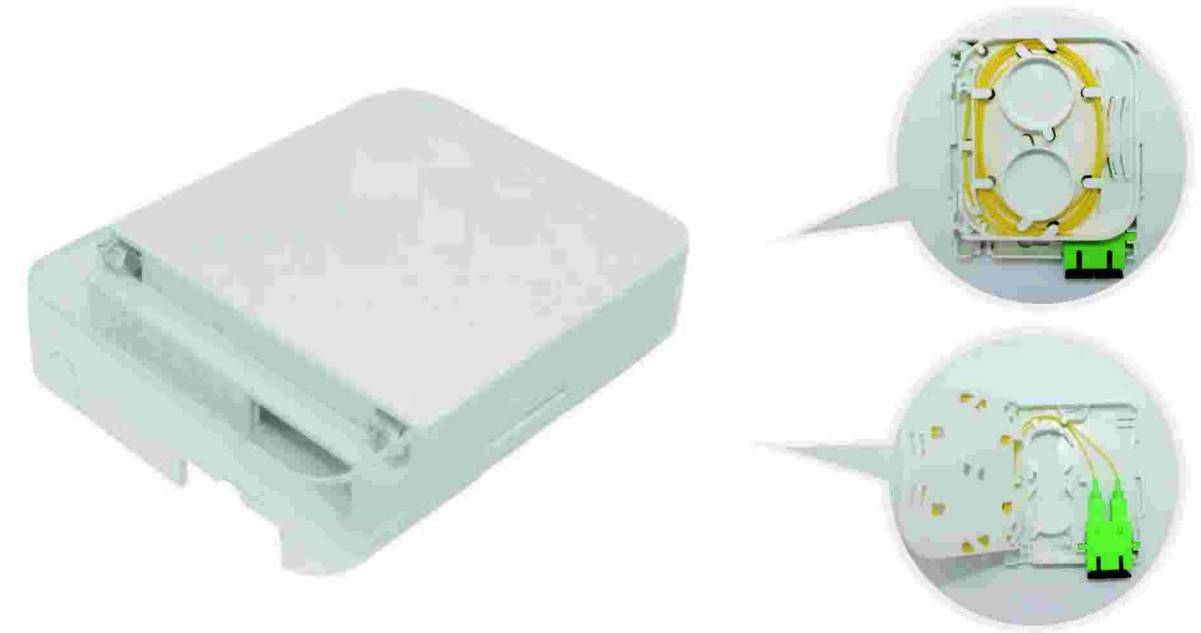

WOT-YF2C-A01

Technical Features

Technical Parameter

- Connector attenuation (insert, interchange, repeat) $\leq 0.2\text{dB}$.
- Return loss: APC $\geq 60\text{dB}$, UPC $\geq 50\text{dB}$.
- During maintenance, clear marking of the optical path could avoid confusion effectively.
- Connector plug durability > 1000 times.

Dimensions and Capacity	
Dimensions (H*W*D)	117mm*86mm*23mm
Weight	80g
Adapter Type	SC Simplex/LC Duplex
Adapter Capacity	2pcs
Working Temperature	-40°C~+65°C

Wall Outlet Box

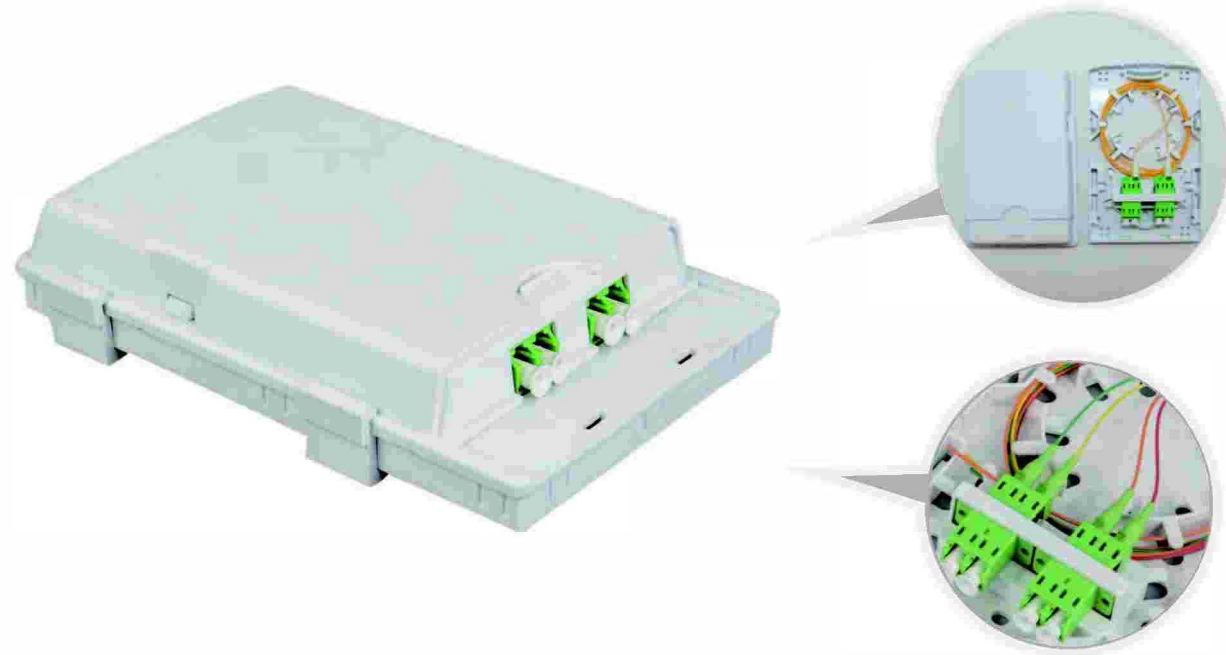

WOT-YF2C-B01

Technical Features

Technical Parameter

- Connector attenuation (insert, interchange, repeat) $\leq 0.2\text{dB}$.
- Return loss: APC $\geq 60\text{dB}$, UPC $\geq 50\text{dB}$.
- During maintenance, clear marking of the optical path could avoid confusion effectively.
- Connector plug durability > 1000 times.

Dimensions and Capacity	
Dimensions (H*W*D)	130mm*83mm*24mm
Weight	60g
Adapter Type	SC Simplex/LC Duplex
Adapter Capacity	2pcs
Working Temperature	-40°C~+65°C

Wall Outlet Box

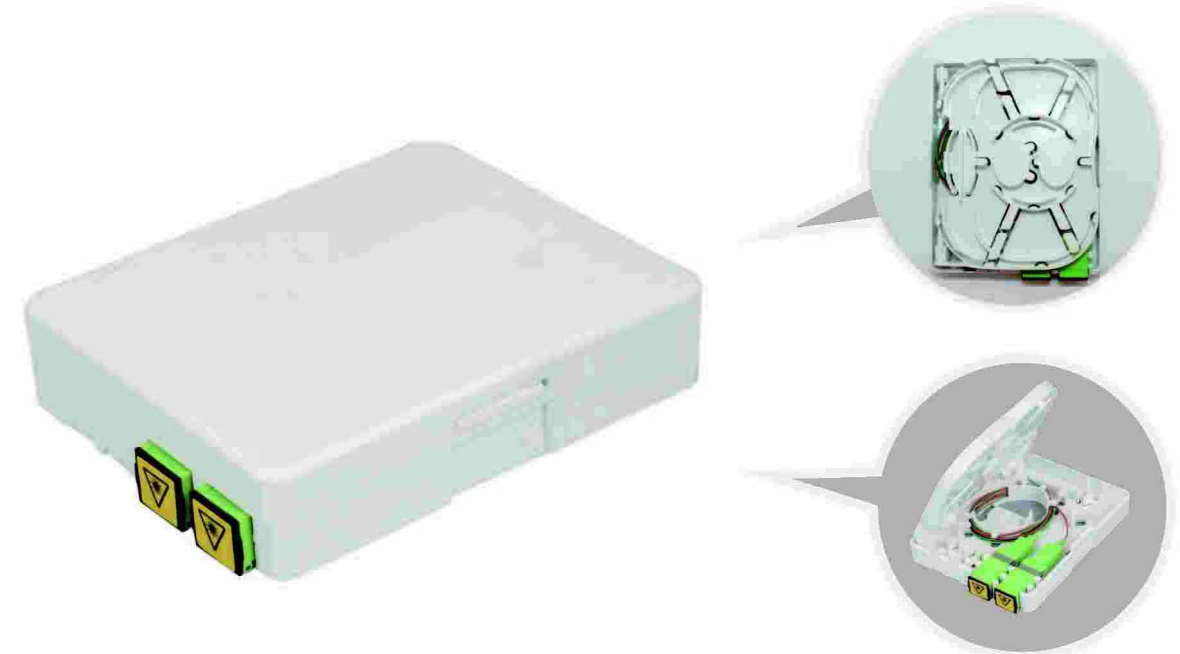

WOT-YF2C-C01

Technical Features

Technical Parameter

- Connector attenuation (insert, interchange, repeat) $\leq 0.2\text{dB}$.
- Return loss: APC $\geq 60\text{dB}$, UPC $\geq 50\text{dB}$.
- During maintenance, clear marking of the optical path could avoid confusion effectively.
- Connector plug durability > 1000 times.

Dimensions and Capacity	
Dimensions (H*W*D)	100mm*80mm*22mm
Weight	75g
Adapter Type	SC Simplex/LC Duplex
Adapter Capacity	2pcs
Working Temperature	-40°C~+65°C

Wall Outlet Box

This mini Fiber Optic Socket Panel fiber optic termination box is used for splicing and termination between indoor fiber optic cable and pigtails with SC or LC duplex type. The termination box is used for wall mounted or desktop applications. Made of the plastic material, is easy to install in home or office. Outlets are designed to fit SC fiber optic cable patch cord adapter, used in work location subsystem.

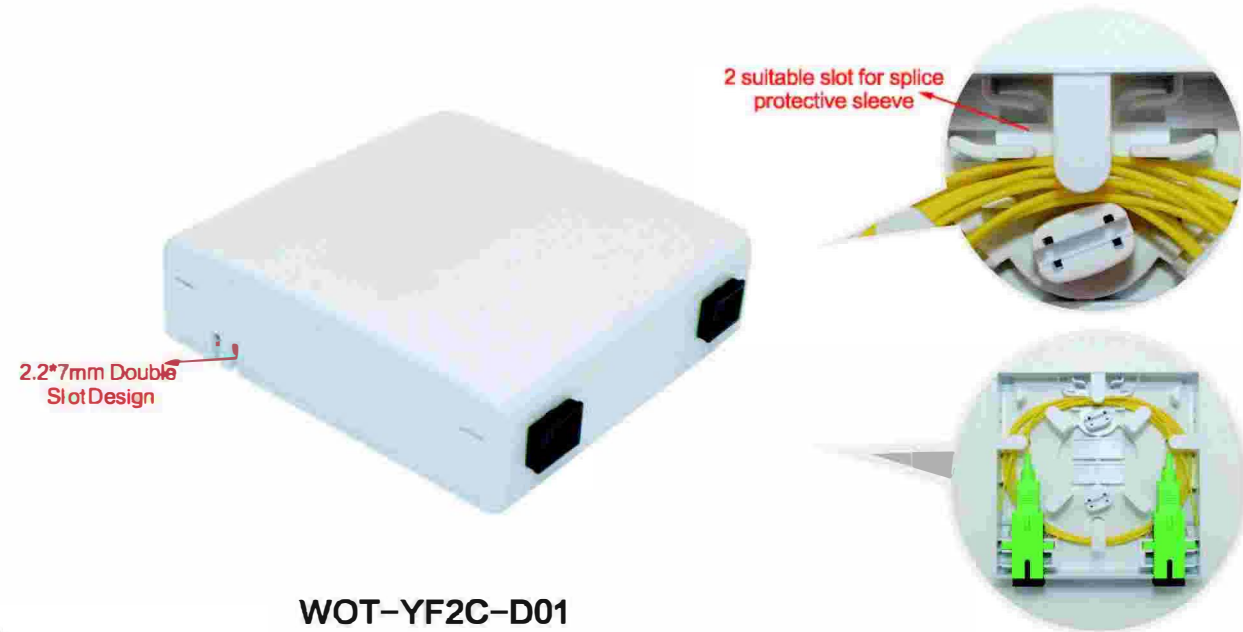

Technical Features

Technical Parameter

- Connector attenuation (insert, interchange, repeat) $\leq 0.2\text{dB}$.
- Return loss: APC $\geq 60\text{dB}$, UPC $\geq 50\text{dB}$.
- During maintenance, clear marking of the optical path could avoid confusion effectively.
- Connector plug durability > 1000 times.

Dimensions and Capacity	
Dimensions (H*W*D)	86mm*86mm*24mm
Weight	50g
Adapter Type	SC Simplex/LC Duplex
Adapter Capacity	2pcs
Working Temperature	-40°C~+65°C

Wall Outlet Box

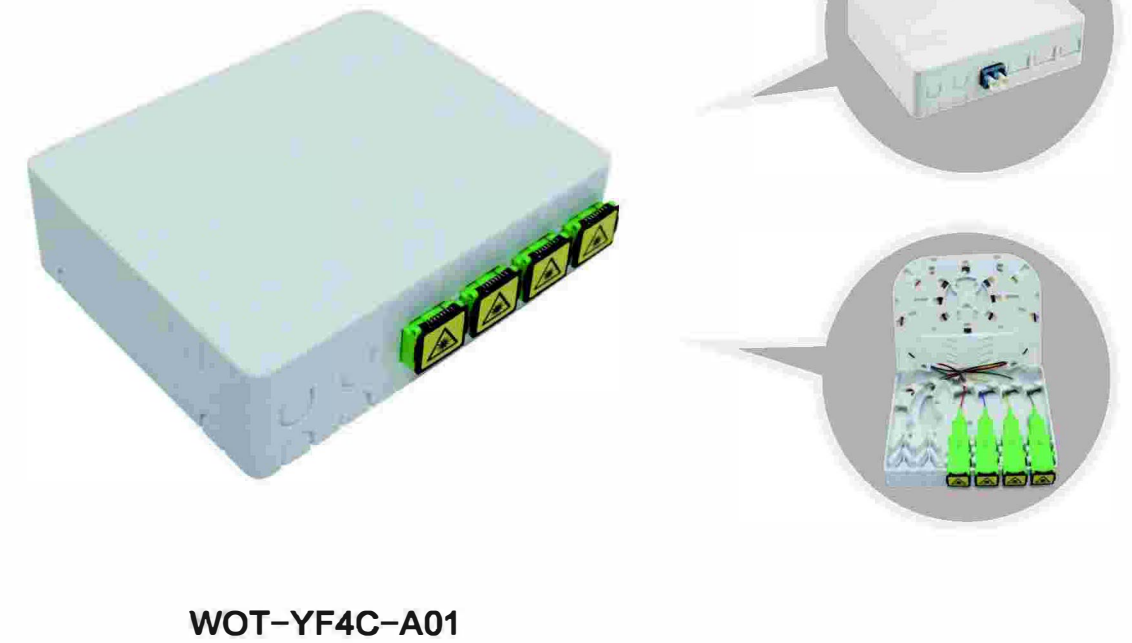

Technical Features

Technical Parameter

- Connector attenuation (insert, interchange, repeat) $\leq 0.2\text{dB}$.
- Return loss: APC $\geq 60\text{dB}$, UPC $\geq 50\text{dB}$.
- During maintenance, clear marking of the optical path could avoid confusion effectively.
- Connector plug durability > 1000 times.

Dimensions and Capacity	
Dimensions (H*W*D)	100mm*80mm*30mm
Weight	75g
Adapter Type	SC Simplex/LC Duplex
Adapter Capacity	4pcs
Working Temperature	-40°C~+65°C

2/4/6 Cores FAT

This distribution box terminates up to 1 fiber optic cables, offers spaces for splitters and up to 2/4/6 fusions, allocates 2/4/6 SC adapters and working under outdoor environments. It is a perfect cost effective solution provider in the FTTx networks.

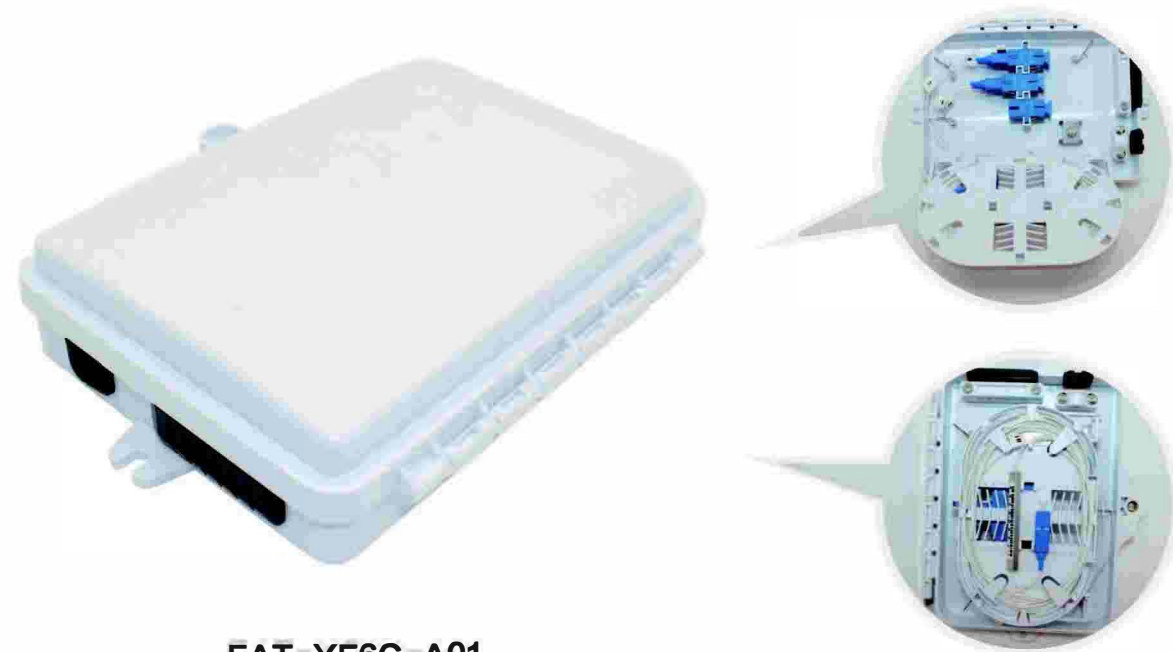

FAT-YF6C-A01

Structure and Technical Features

Structure Features

- Splice and patch cord use Separation structure easy to Capacity expansion and maintenance;
- High quality plastic , Beautiful appearance;
- Internal turnover structure, easy to maintenance;
- Can install 2/4/6 pcs of SC adapters;
- Can install mini type splitter;
- Could exit 2/4/6 pcs of drop cable;
- Protection levels: IP65

Main mechanical parameters

- During maintenance ,clear marking of the optical path could avoid confusion effectively .Connector plug durability >1000 times.Working Temperature:-40℃~+65℃

Dimensions and Capacity

Dimensions (H*W*D)	196mm*144mm*41mm
Weight	0.25KG
Adapter Type	SC Simplex/LC Duplex
Adapter Capacity	2/4/6pcs
Splitter Type	1*6 Mini type splitter
Number of Cable Entrance(s) and Exit(s)	1:2/1:4/1:6
Cable Inlet Caliber	9mm
Optional Accessories	Adapters, Pigtails, Heat Shrink Tubes, Micro Splitter

8 Cores FAT

This distribution box terminates up to 2 fiber optic cables, offers spaces for splitters and up to 8 fusions, allocates 8 SC adapters and working under outdoor environments. It is a perfect cost-effective solution-provider in the FTTx networks.



FAT-YF8C-A01

Structure and Technical Features

Structure Features

- Splice and patch cord use Separation structure easy to Capacity expansion and maintenance;
- High quality plastic , Beautiful appearance;
- Internal turnover structure, easy to maintenance;
- Can install 8 pcs of SC adapters;
- Can install mini type splitter;
- Could exit 8 pcs of drop cable;
- Protection levels: IP65

Main mechanical parameters

- During maintenance ,clear marking of the optical path could avoid confusion effectively .Connector plug durability >1000 times.Working Temperature:-40℃~+65℃

Dimensions and Capacity

Dimensions (H*W*D)	243mm*195mm*55mm
Weight	0.56KG
Adapter Type	SC Simplex/LC Duplex
Adapter Capacity	8pcs
Splitter Type	1*8 Mini type splitter
Number of Cable Entrance(s) and Exit(s)	2:8/3:8
Cable Inlet Caliber	12mm
Optional Accessories	Adapters, Pigtails, Heat Shrink Tubes, Micro Splitter

12 Cores FAT

This distribution box terminates up to 2 fiber optic cables, offers spaces for splitters and up to 12 fusions, allocates 12 SC adapters and working under outdoor environments. It is a perfect cost-effective solution-provider in the FTTx networks.



FAT-YF12C-A01

12 Cores FAT

This distribution box terminates up to 2 fiber optic cables, offers spaces for splitters and up to 12 fusions, allocates 12 SC adapters and working under outdoor environments. It is a perfect cost-effective solution-provider in the FTTx networks.

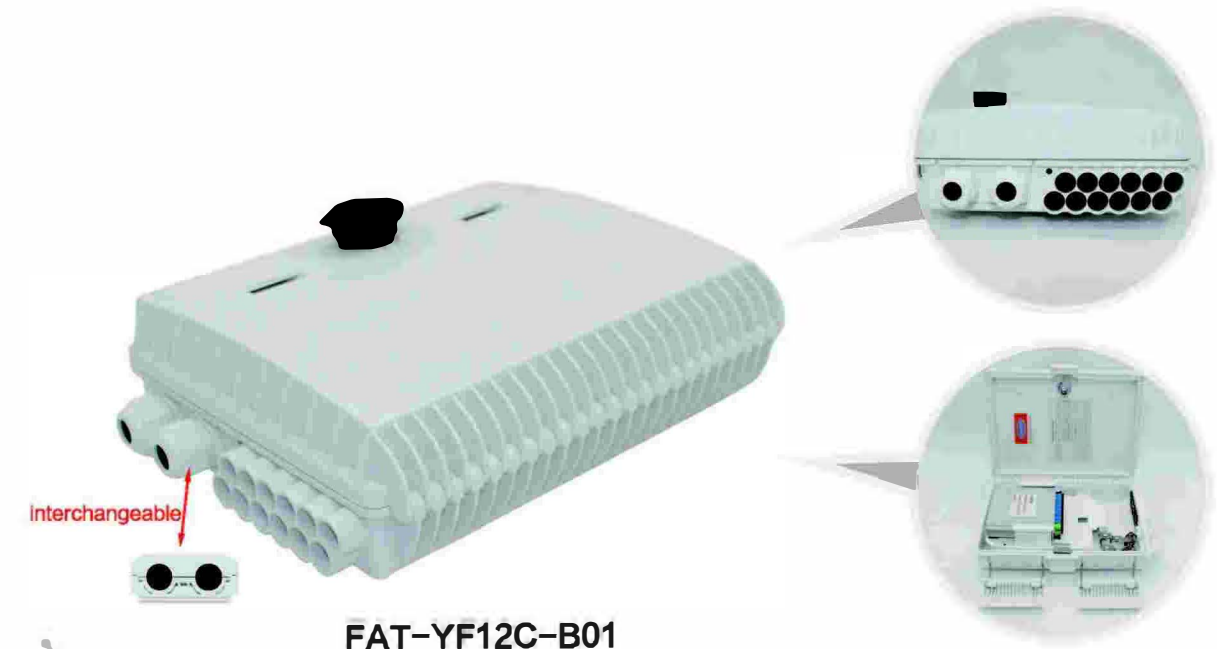

FAT-YF12C-B01

Structure and Technical Features

Structure Features

- Splice and patch cord use Separation structure easy to Capacity expansion and maintenance;
- High quality plastic , Beautiful appearance;
- Internal turnover structure, easy to maintenance;
- Can install 12 pcs of SC adapters;
- Can install mini type splitter; ;
- Could exit 12pcs of drop cable;
- Protection levels: IP65

Main mechanical parameters

- During maintenance ,clear marking of the optical path could avoid confusion effectively .Connector plug durability >1000 times.Working Temperature:-40℃~+65℃

Dimensions and Capacity

Dimensions (H*W*D)	232mm*213mm*69mm
Weight	0.73KG
Adapter Type	SC Simplex/LC Duplex
Adapter Capacity	12pcs
Splitter Type	1*4/1*8 Mini type splitter
Number of Cable Entrance(s) and Exit(s)	2:12
Cable Inlet Caliber	13mm
Optional Accessories	Adapters, Pigtails, Heat Shrink Tubes, Micro Splitter

Structure and Technical Features

Structure Features

- Splice and patch cord use Separation structure easy to Capacity expansion and maintenance;
- High quality plastic , Beautiful appearance;
- Internal turnover structure, easy to maintenance;
- Can install 12 pcs of SC adapters;
- Can install Cassette PLC splitter;
- Could exit 12pcs of drop cable;
- Protection levels: IP65

Main mechanical parameters

- During maintenance ,clear marking of the optical path could avoid confusion effectively .Connector plug durability >1000 times.Working Temperature:-40℃~+65℃

Dimensions and Capacity

Dimensions (H*W*D)	267mm*208mm*96mm
Weight	1 KG
Adapter Type	SC Simplex/LC Duplex
Adapter Capacity	12pcs
Splitter Type	1*8 Cassette PLC splitter
Number of Cable Entrance(s) and Exit(s)	2:12
Cable Inlet Caliber	13mm
Optional Accessories	Adapters, Pigtails, Heat Shrink Tubes, Micro Splitter

16 Cores FAT

This distribution box terminates up to 2 fiber optic cables, offers spaces for splitters and up to 16 fusions, allocates 16 SC adapters and working under outdoor environments. It is a perfect cost-effective solution-provider in the FTTx networks.

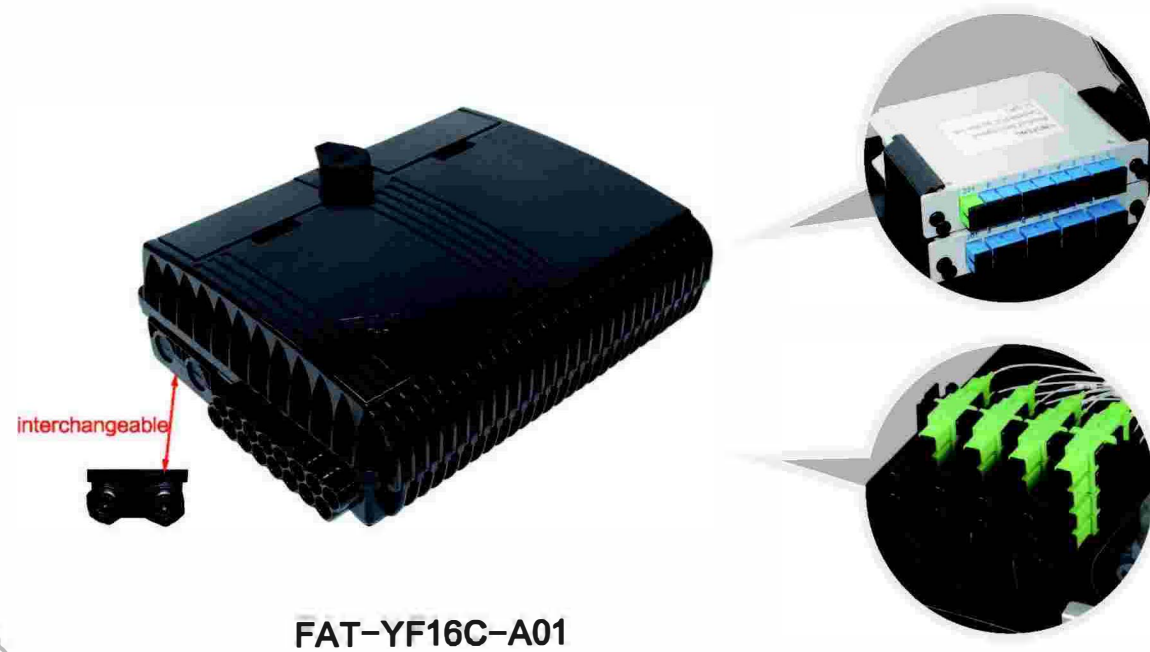

FAT-YF16C-A01

Structure and Technical Features

Structure Features

- Splice and patch cord use Separation structure easy to Capacity expansion and maintenance;
- High quality plastic , Beautiful appearance;
- Internal turnover structure, easy to maintenance;
- Can install 16 pcs of SC adapters;
- Can install Cassette PLC splitter/mini type splitter;
- Could exit 16 pcs of drop cable;
- Protection levels: IP65

Main mechanical parameters

- During maintenance ,clear marking of the optical path could avoid confusion effectively .Connector plug durability >1000 times.Working Temperature:-40℃~+65℃

Dimensions and Capacity

Dimensions (H*W*D)	303mm*236mm*109mm
Weight	1.35KG
Adapter Type	SC Simplex/LC Duplex
Adapter Capacity	16pcs
Splitter Type	1*8 /1*16 Cassette PLC splitter,1*8/1*16 mini type splitter
Number of Cable Entrance(s) and Exit(s)	2:16
Cable Inlet Caliber	16mm
Optional Accessories	Adapters, Pigtails, Heat Shrink Tubes, Micro Splitter

16 Cores FAT

This distribution box terminates up to 2 fiber optic cables, offers spaces for splitters and up to 16 fusions, allocates 16 SC adapters and working under outdoor environments. It is a perfect cost-effective solution-provider in the FTTx networks.

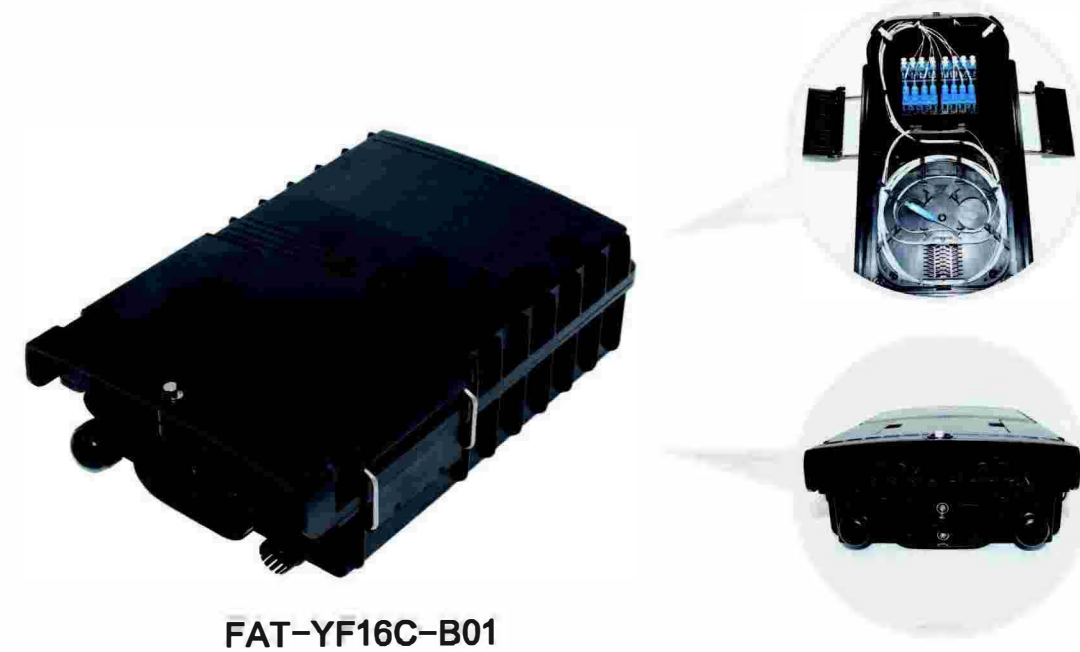

FAT-YF16C-B01

Structure and Technical Features

Structure Features

- Splice and patch cord use Separation structure easy to Capacity expansion and maintenance;
- High quality plastic , Beautiful appearance;
- Internal turnover structure, easy to maintenance;
- Can install 16 pcs of SC adapters;
- Can install mini type splitter;
- Could exit 16 pcs of drop cable;
- Protection levels: IP65

Main mechanical parameters

- During maintenance ,clear marking of the optical path could avoid confusion effectively .Connector plug durability >1000 times.Working Temperature:-40℃~+65℃

Dimensions and Capacity

Dimensions (H*W*D)	289mm*183mm*83mm
Weight	0.9KG
Adapter Type	SC Simplex/LC Duplex
Adapter Capacity	16pcs
Splitter Type	1*8/1*16 mini type splitter
Number of Cable Entrance(s) and Exit(s)	4:16
Cable Inlet Caliber	Two inlets are 14mm and the other two are 12mm
Optional Accessories	Adapters, Pigtails, Heat Shrink Tubes, Micro Splitter

24 Cores FAT

This distribution box terminates up to 2 fiber optic cables, offers spaces for splitters and up to 24 fusions, allocates 24 SC adapters and working under outdoor environments. It is a perfect cost-effective solution-provider in the FTTx networks.



FAT-YF24C-A01

Structure and Technical Features

Structure Features

- Splice and patch cord use Separation structure easy to Capacity expansion and maintenance;
- High quality plastic , Beautiful appearance;
- Internal turnover structure, easy to maintenance;
- Can install 24 pcs of SC adapters;
- Can install mini type splitter;
- Could exit 24 pcs of drop cable;
- Protection levels: IP65

Main mechanical parameters

- During maintenance ,clear marking of the optical path could avoid confusion effectively .Connector plug durability >1000 times.Working Temperature:-40℃~+65℃

Dimensions and Capacity

Dimensions (H*W*D)	330mm*275mm*101mm
Weight	1.25KG
Adapter Type	SC Simplex/LC Duplex
Adapter Capacity	24pcs
Splitter Type	1*8/1*16 mini type splitter
Number of Cable Entrance(s) and Exit(s)	2:24
Cable Inlet Caliber	16mm
Optional Accessories	Adapters, Pigtails, Heat Shrink Tubes, Micro Splitter

48 Cores Dome Type FOSC Mechanical Seal Type

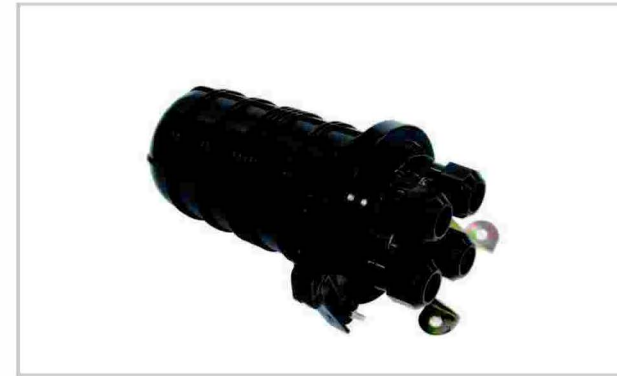

FOSC-YF48V-A01

48 Cores Dome Type FOSC Heat shrink Type



FOSC-YF48V-B01

FOSC Heat Shrink Seal Type /Performance Parameter Table

Part number	FOSC-YF48V-A01	FOSC-YF48V-B01
Dimensions	H300xD185mm	H300xD185mm
Weight	1.1kg	1.1kg
Number of Cable Entrance/Exit	2:2	1:3
Diameter of Cable ports	4xRound:Φ22mm	1xOval:Φ19x30mm 3xRound:Φ18mm
Protection Grade	IP68	IP68
Working Temperature	-40℃~+65℃	-40℃~+65℃

48 Cores Dome Type FOSC Mechanical Seal Type



FOSC-YF48V-A02

96 Cores Dome Type FOSC Mechanical Seal Type



FOSC-YF96V-A01 480mmx240mm

FOSC-YF96V-B01 430mmx225mm

48 Cores Dome Type FOSC Heat Shrink Type



FOSC-YF48V-B02

144 Cores Dome Type FOSC Mechanical Seal Type



FOSC-YF144-A01 480mmx240mm

144 Cores Dome Type FOSC Heat shrink Type



FOSC-YF144-B01 480mmx240mm

FOSC Heat Shrink Seal Type
/Performance Parameter Table

Part number	FOSC-YF48V-A02	FOSC-YF48V-B02
Dimensions	H460xD223mm	H460xD223mm
Weight	0.9kg	0.9kg
Number of Cable Entrance/Exit	2:2	1:3
Diameter of Cable ports	4xRound:Φ23mm	1xOval:Φ33x57mm 3xRound:Φ23mm
Protection Grade	IP68	IP68
Working Temperature	-40℃~+65℃	-40℃~+65℃

48 Cores Horizontal FOSC Mechanical Seal Type



FOSC-YF48H-A01

96 Cores Horizontal FOSC Mechanical Seal Type

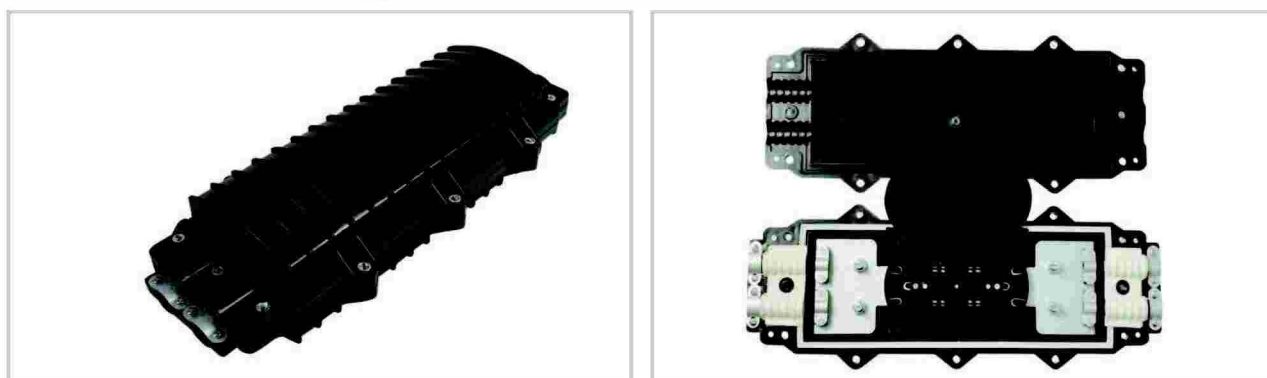

FOSC-YF96H-A01

Horizontal FOSC
/Performance Parameter Table

Part number	FOSC-YF48H-A01	FOSC-YF96H-A01
Dimensions	415x165x95mm	450x177x110mm
Weight	1.7kg	1.6kg
Number of Cable Entrance/Exit	2:2	2:2
Diameter of Cable ports	Oval: $\Phi 10 \times 16 \text{mm}$	Oval: $\Phi 10 \times 16 \text{mm}$
Protection Grade	IP68	IP68
Working Temperature	-40°C~+65°C	-40°C~+65°C

96 Cores Fiber Management Closure

FATC-YF96C-A01 is designed to seal without screws. The compact size and flip-over cover bring easy operation as well as complete function. The splice trays are jointed with a hinge at one side, which makes the operation in each tray easier. It is designed to prevent from operation damage.

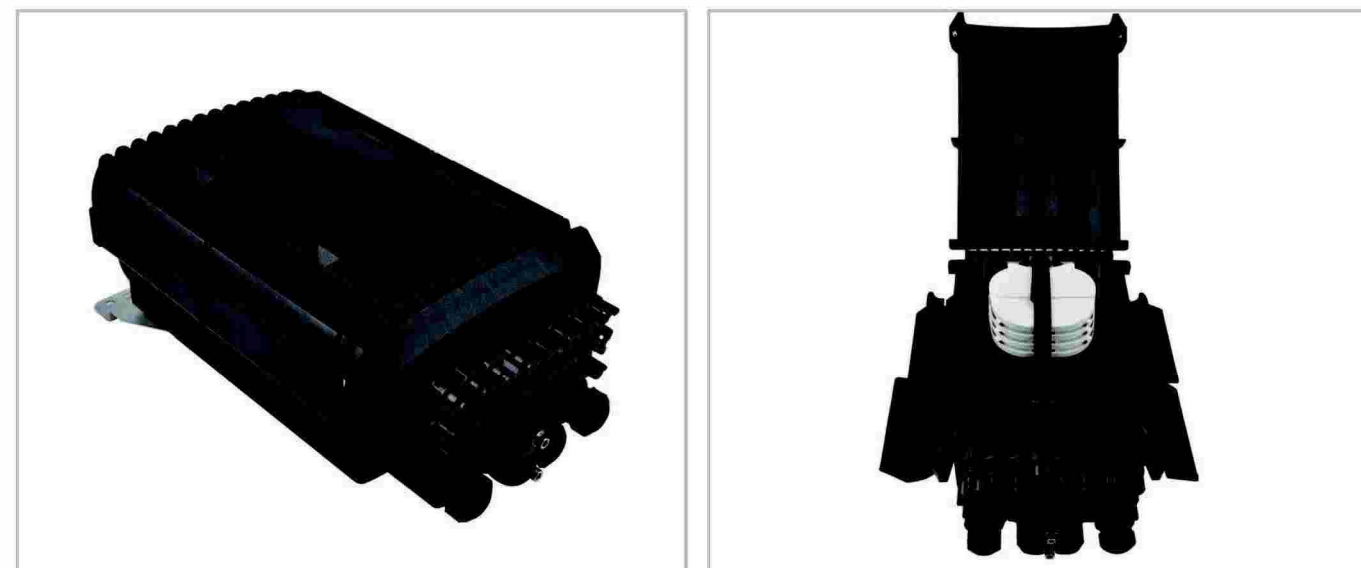

FATC-YF96C-A01

Structure and Technical Features

Structure Features

- Water-proof design with IP-68 Protection level.
- Integrated with flap-up splice trays.
- Impact test: IK10, Pull Force:100N, Full rugged design.
- All stainless metal plate, anti-rust bolts and nuts.
- Fiber bend radius control more than 40mm.
- Full mechanical sealing mechanism.

Main mechanical parameters

- During maintenance ,clear marking of the optical path could avoid confusion effectively . Connector plug durability > 1000 times.

Dimension(mm)	380x245x130	Max.capacity(Single fiber)	96
Weight(kg)	4.5~5	Sealing type	Mechanical
Cable ports	1 input cable port for un-cut cable from diameter from 10~17.5mm. 2 output cable ports for cable diameter from 8~17.5mm. 16 output cable ports for cable diameter less than 4mm.	Single splice tray capacity (Single fiber)	24
Splice tray quantity	1~4		

288 Cores Fiber Management Closure

FATC-YF288C-A01 is designed to seal without screws. The compact size and flip-over cover bring easy operation as well as complete function. The splice trays are jointed with a hinge at one side, which makes the operation in each tray easier. It is designed to prevent from operation damage.

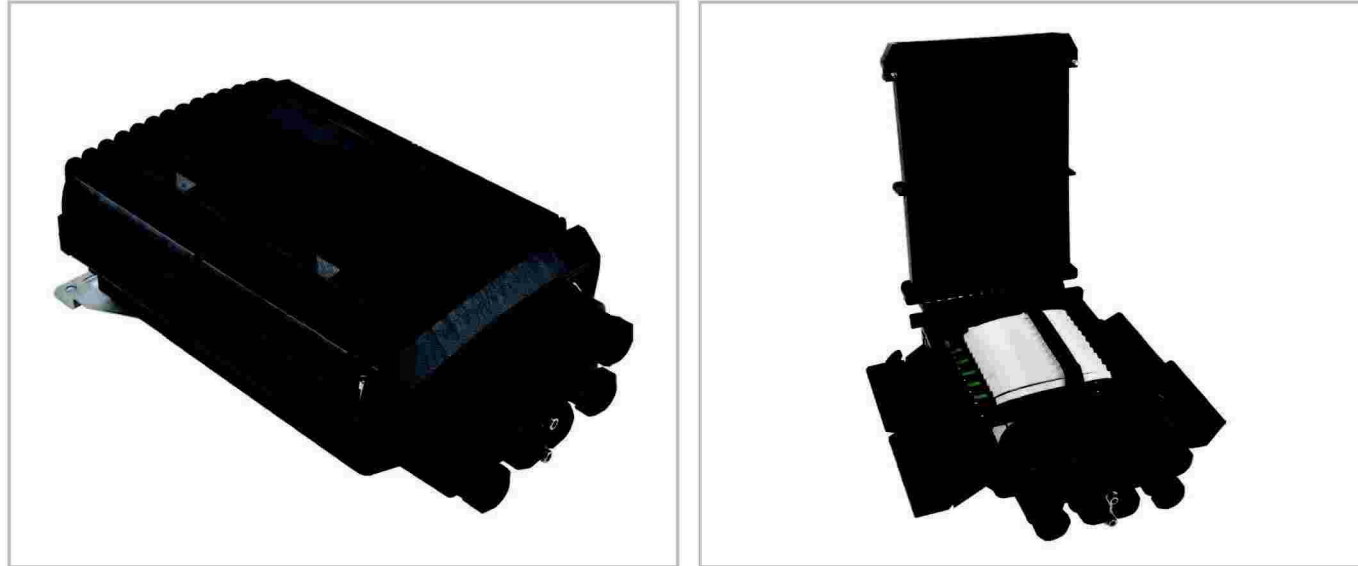

FATC-YF288C-A01

Structure and Technical Features

Structure Features

- Water-proof design with IP-68 Protection level.
- Integrated with flap-up splice trays.
- Impact test: IK10, Pull Force:100N, Full rugged design.
- All stainless metal plate, anti-rust bolts and nuts.
- Fiber bend radius control more than 40mm.
- Full mechanical sealing mechanism.

Main mechanical parameters

- During maintenance ,clear marking of the optical path could avoid confusion effectively . Connector plug durability > 1000 times.

Dimension(mm)	395x245x130	Max.capacity(Single fiber)	288
Weight(kg)	5	Sealing type	Mechanical
Cable ports	1 input cable port for un-cut cable from diameter from 10~17.5mm. 6 output cable ports for cable diameter from 8~17.5mm.	Single splice tray capacity (Single fiber)	24
Splice tray quantity	1~12		

Optical Distribution Frame (ODF)

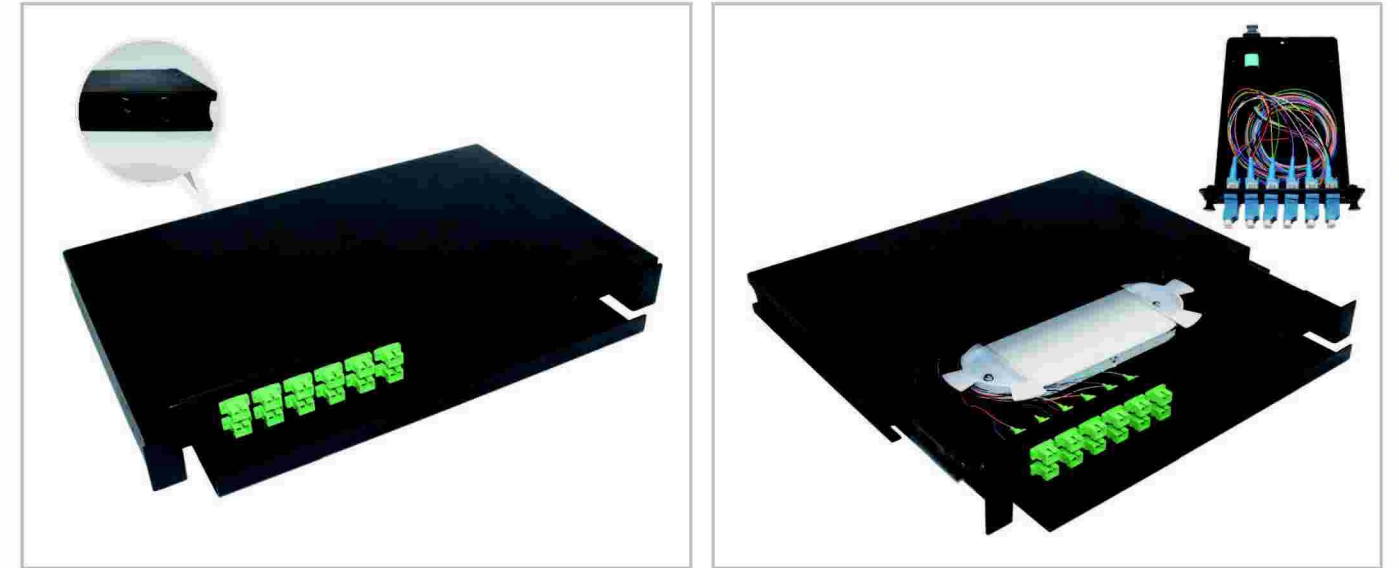

ODF-YF24C-A01

Structure and Technical Features

Structure Features

- Telecom Standard Production
- The traction structure with fusion and matching integration has the advantages of large capacity, high density, more stability and smoothness.
- Flange is easy to connect, low attenuation loss, and data is smooth.
- Surface wear-resistant, rust-proof, environmental protection, beautiful, long service life.

Main mechanical parameters

- During maintenance ,clear marking of the optical path could avoid confusion effectively . Connector plug durability > 1000 times.

Product parameters	ODF-YF24C-A01
Dimensions (H*W*D)	480mm*400mm*50mm
Connector Type	SC LC FC ST adapter
Fiber Type	Simplex Duplex
Application:	FTTH FTTB FTTX Network
Model	Rack Mount
Ports	24 Ports